

No. 7 March Term, 1882

Review Vacate And  
Supply Public Road

VERSUS

Chest Townships

Contents:

R. S. 22 - Page 151

Part Pt. 221

To the Honourable the Judges of  
the Court of common Pleas in the  
County of Clearfield now composing  
a Court of Quarter sessions of the peace  
in and for said County

The petition of divers inhabitants  
of the Township of Chesters in said  
County humbly sheweth that they  
labor under great inconvenience  
for a review of a road on the east  
side of Chest Creek starting at the  
Waggoner bridge and intersect  
the public road at or near James  
Currys signpost Camp and also to  
vacate a road starting on the east  
side of Chest Creek crossing the  
creek and intersecting the old  
Washington at the end of James  
Currys lane and your petition  
ers humbly pray the court

to appoint proper persons  
to view and vacate and supply  
the same according to law  
and they will pray &c

James Curry  
M. A. Pierce  
Frank Cook  
George Bishop  
J. L. Kitchen  
A. L. Kitchen  
Wm. Bloom  
J. T. Scott  
H. ...  
Michael  
Wm. H. Phillips  
Ed. Woods  
John Riving

No 7 Town of March,

Section of Burgess of

West Township for  
Review of a Road on  
the East side of West  
Creek starting at the  
West 9th Bridge and  
intersecting the Public Road  
at or near Jamesburg  
Sugar Camp and also  
locate a Road  
starting on the East side  
of West Creek crossing  
the creek and intersecting  
the Public Road at  
Jamesburg and Jamesburg

and now, March 20<sup>th</sup>  
at 1882, S. A. McCluskey  
D. W. Moon and John  
Pallman are appointed  
viewers -

John McCluskey

S. A.

Wilson

To the Honorable the Judges of the  
Court of Clearfield County.

We the undersigned viewers appointed by the annexed Order of Court to view and lay out the road therein mentioned respectfully Report that we met on the ground on the day appointed, and being all present, and all being duly sworn or affirmed, in pursuance of the said order of Court, we did view and lay out, and do return the following Road, viz: <sup>in the township road</sup> Beginning at a post in James Currys sugar Camp thence through land of E. A. Irwin South five and a half degrees west twenty-two perches to a post on the bank of Chest creek; thence up said <sup>creek</sup> South forty-two and a half degrees east fifteen perches to a post, South thirty-seven degrees east sixteen perches to a post, South six degrees east twenty-three perches to a post, South fourteen degrees and a half degrees east nine perches to a post, South thirty-nine degrees east twenty-three perches to a post, South fourteen and a half degrees ~~west~~ west four perches to the end of the bridge across the said Chest creek at William H. Wagner's house - which said Road as above described we are of opinion is necessary for public use - a draft whereof is hereto annexed.

We are further directed by the said Order to vacate the road from the East side of said creek to the Township road leading to the Washington, which duty we have performed, and do return the following Road, which we declare vacated Beginning at the township road leading to

New Washington at the end of James Cunniff  
lane, thence through land of James Cunniff north  
Twenty degrees east Twenty-eight perches; north twelve  
and a quarter degrees east eighteen perches; South  
Eighty-nine and a half degrees east fourteen  
perches; north twenty-five degrees east ten perches;  
north twenty and a half degrees west nine perches;  
north thirteen degrees east ten perches; north fifty-  
eight degrees east ten perches; thence through land  
of E. A. Levin south thirty degrees east twenty-two  
perches to a post in the line of Road returned in  
this Report as shown by the red lines on the an-  
nexed Draft

There are no damages claimed for  
the above Road, and no person, in our opinion,  
is entitled to any.

Witness our hands the 11<sup>th</sup> day of  
April A. D. 1882

D. W. Moore } Deems  
J. L. Patterson }

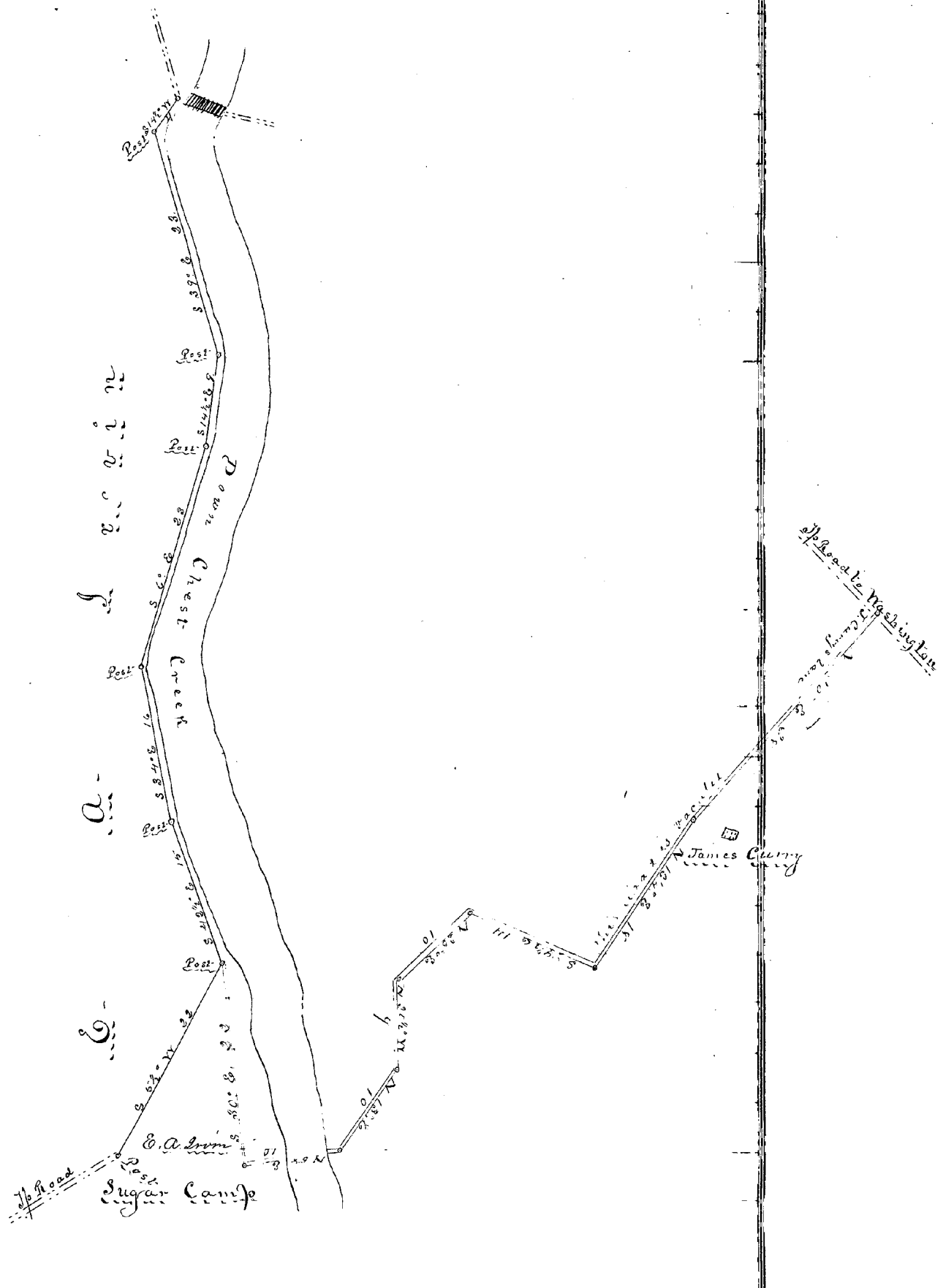

## CLEARFIELD COUNTY, SS.

At a Court of Quarter Sessions of the Peace of the county of  
Clearfield, held at Clearfield, in and for said county, on the  
20<sup>th</sup> day of March, A.D. 1887  
before Judges of said Court, upon a petition of sundry inhab-  
itants of the township of Chest, in  
said county, setting forth that They labor

under great inconvenience for want of  
a Public Road the Petitioners having  
to lay out a Public Road from Maguire's to  
intersect the Public Road at or near James  
Curry's Sugar Camp and also vacate a Road  
starting on the East side of Chest Creek and  
intersecting the new Washington Road at or near  
the End of James Curry's Lane

and therefore praying the Court to appoint proper persons to view and lay out the same  
according to law,

whereupon the Court, upon due consideration had of the premises, do order and appoint  
Samuel McCloskey, D. W. Moore & John Patterson  
who, after being respectively sworn or affirmed to perform the duties of their appointment  
with impartiality and fidelity, are to view the grounds proposed for said road, and if they  
view the same and any two of the actual viewers agree that there is occasion for such road,  
they shall proceed to lay out the same agreeable to the desire of the petitioners, as may be, having  
respect to the best ground for a road and the shortest distance, and in such manner as to do  
least injury to private property, and state particularly whether they judge the same necessary  
for a public or private road, together with a plot or draft of the same, with the courses and  
distances and reference to the improvements through which it passes, and shall also procure  
releases of damages from persons through whose lands said road may pass, or failing to  
procure such releases, shall assess the same, if any sustained, and shall make report thereof  
to the next Court of Quarter Sessions to be held for the said county, in which report they shall  
state that they have been sworn and affirmed according to law. Notice is directed to be  
given to the owners or occupants of seated lands through which the within road is intended  
to pass, of the time of the view, according to the 147th Rule of Court.

BY THE COURT.

James Kerr  
CLERK.

## RELEASE OF DAMAGES.

KNOW ALL MEN BY THESE PRESENTS: That we, the undersigned, owners of lands through which the road located by the viewers, under the annexed order, passes, for and in consideration of the sum of ONE DOLLAR to us respectively paid by the \_\_\_\_\_ at and before the enseatling and delivery hereof, have remised, released and forever quit-claimed and do hereby remise, lease and forever quit-claim to the said \_\_\_\_\_ all damages that may arise to us respectively by reason of the location and opening of the said road; so that neither we, nor any of us, nor any person claiming under us, can or may hereafter ask, sue for, demand, have or receive any damages for injuries arising or growing out of the location and opening of the road aforesaid.

Witness our hands and seals this \_\_\_\_\_ day of \_\_\_\_\_  
A. D. 188 .

+++++  
[L. S.]  
+++++

+++++  
[L. S.]  
+++++

+++++  
[L. S.]  
+++++

+++++  
[L. S.]  
+++++

## ASSESSMENT OF DAMAGES.

The following persons, having refused to release the damages to which they respectively may be entitled by reason of the location and the opening of the said road in the annexed return described, we, the undersigned viewers, under oath in pursuance of our duty, under the Act of Assembly do assess their damages and make report thereof, as follows:

To \_\_\_\_\_ the sum of \_\_\_\_\_

To \_\_\_\_\_ the sum of \_\_\_\_\_

To \_\_\_\_\_ the sum of \_\_\_\_\_

Witness our hands this \_\_\_\_\_ day of \_\_\_\_\_ A. D. 188 .



NOTE: In case of a *Prithane* flood, the release must be executed in favor of the *pothi* for solid road.

Also— Viewers will carefully note the number of days employed and set the amount out at the foot of their return.

Reviewers cannot interfere so far as the location may be chosen by the viewers.

X. B.—If the viewers deliver the parties are not entitled to damages, taking into consideration the advantages as well as the disadvantages of the road, they will report to the effect.

*L. J. M. Black* } *Days 2* ..... *Amount*  
*Miles 21* } *Cost No 147*

John & Patterson { Days 3  
Miles 27

*S. W. Moore* . . . . . { Days 2  
Miles 27 . . . . .

Mr. Geo. Thompson { Days .....  
(Carrying down) Miles .....

Stand, *Middle* { Days .....  
(camping place) Miles.....

No. 7 March Session, 1852

**DRUGS**

To view and lay out a Road  
To Julia in the township  
of Wheat Clearfield county.

sent under 23<sup>rd</sup> May 1882  
referred back to museum for  
examination, by Mr. Deane  
Edw. H. Griffiths

between 7<sup>th</sup> & 8<sup>th</sup> May, 1821 compared  
 nicely, and the difference 133 feet  
 wide, except when dipping and  
 ridings are required by the  
 10 to 15 yards by the road.  
 A. Smith.

29 The plate is confirmed absolutely  
by the receipt  
of the British Museum

Filed: 23 May, 1882

25  
Fees \$1, paid by *James Murray*