

No. 3, December Term, 1892

Public Road

Versus

Fancy Runship

Contents:

Vol. 3 - Page 255

Pant. Ct. 17072
Twp. Rd. 17383

Clearfield County, ss: (C)

At a Court of Quarter Sessions of the Peace of the county of Clearfield, Pennsylvania, held at Clearfield, in and for said county, on the 3^d day of December, A. D. 1880, before Judges of said Court, upon a petition of sundry inhabitants of the township of Dandy, in said county, setting forth that they have under

great inconvenience for want of a public road
Starting at what is known as Rockys Sawmill
on the DuBois & Luthersburg road and ending
at or near the oak timber on the lands of
Andrew Pitz Jr.

and therefore praying the Court to appoint proper persons to view and lay out the same according to law, Make report at next term 1881
whereupon the Court, upon due consideration had of the premises, do order and appoint David Reams J. Laylin & Hamilton who, after being respectively sworn or affirmed to perform the duties of their appointment with impartiality and fidelity, are to view the grounds proposed for said road, and if they view the same and any two of the actual viewers agree that there is occasion for such road, they shall proceed to lay out the same agreeable to the desire of the petitioners, as may be, having respect to the best ground for a road and the shortest distance, and in such manner as to do least injury to private property, and state particularly whether they judge the same necessary for a PUBLIC or PRIVATE road, together with a plot or draft of the same, with the courses and distances and reference to the improvements through which it passes, and shall also procure releases of damages from persons through whose lands said road may pass, or failing to procure such releases, shall assess the same, if any sustained, and shall make report thereof to the next Court of Quarter Sessions to be held for said county, in which report they shall state that they have been sworn and affirmed according to law. Notice is directed to be given to the owners or occupants of seated lands through which the within road is intended to pass, of the time of the view, according to the 147th Rule of Court.



BY THE COURT.



AM Blinn
CLERK.

RELEASE OF DAMAGES.

Know all Men by these Presents, That we, the undersigned, owners of lands through which the road located by the viewers, under the annexed order, passes, for and in consideration of the sum of ONE DOLLAR to us respectively paid by the _____ at and before the ensembling and delivery hereof, have remised, released and forever quit-claimed, and do hereby remise, release and forever quit-claim to the said _____ all damages that may arise to us respectively by reason of the location and opening of the said road, so that neither we nor any of us, nor any person claiming under us, can or may hereafter ask, sue for, demand, have or receive any damages for injuries arising or growing out of the location and opening of the road aforesaid.

Witness our hands and seals this 1st day of May
A. D. 1891

Henry A. G. Lamm 
Henry A. Lamm 

Assessment of Damages.

The following persons, having refused to release the damages to which they respectively may be entitled by reason of the location and the opening of the said road in the annexed return described, we, the undersigned viewers, under oath in pursuance of our duty, under the Act of Assembly, do assess their damages and make report thereof, as follows:

To J. C. Rockey the sum of Twenty-five (\$25.) dollars
To _____ the sum of _____
To _____ the sum of _____

Witness our hands this 1st day of May, A. D. 1891.

David Reams
J. P. Taylor
J. Hamilton

Book 274 pg

No. 3 Dec Sessions, 1890

ORDER

To view and lay out a road for
Public use in the township of
Dancy, Clearfield Co.

Sept 1891 Confirmed in Dec
Road to be opened 33 feet wide
East side hill cutting on south
bankment there 16 feet
By the Court
So the order is by the Court
Dec Sep 1891 Confirmed and
ordered on by the Court.

Answer 14 Jan 1892 after considera-
tion had the Repatification is
Confirmed absolute
By the Court
J. R. K. J.

Filed 11 May 1891
20
Fees \$1, paid by H. C. Cole

Commenced this 1st Aug 1891

Note.—In case of a private road, the release must be executed in favor of the petitioner for said road.
Also—Viewers will carefully note the number of days employed and set the amount out at the foot of their return.
Reviewers cannot interfere with damages assessed by the original viewers, except so far as the location may be changed by the reviewers.
N. B.—If the viewers believe the parties are not entitled to damages, taking into consideration the advantages as well as the disadvantages of the road, they will report to that effect.

David Rogers (Cut # 913)	Days 2 Miles 8	Amount \$ 8.80
Samuelton (Cut # 914)	Days 1 Miles 6	2.60
J. P. Taylor (Cut # 947)	Days 1 Miles 2	2.20
Henry Solada	Days 1 Miles	1.50
Cl. Shaffer	Days 1 Miles	1.50

To the Honorable the Judges of the Court of
Quarter Sessions of Clearfield County

We the undersigned viewers appointed by the
annexed order of Court to view and lay out the road
therein mentioned respectfully report:—

That having given due and public notice of
the time and place of said view by printed handbills
as required by the act of Assembly, we met at the time
and place appointed, and after being duly sworn or affirmed
according to law, and all the viewers being present, we
went upon the ground proposed for said view, and
having viewed the same, we report for Public use the
following road, to wit:— Beginning at the Public road
leading from Luthersburg to DuBois and known as the hill
road at a point on line of Sandy & Brady Township
Thence through timber lands of Andrew Penty sen. in Sandy Twp
N. 77 deg. West 13 per. to a post; Thence N. 57 deg. West 45 per
to a pine Stump; Thence South 87 deg. West 44 per to a dead
hemlock tree on the South side of the run; Thence N. 75½
deg. West 71 per. to a post on timber land of Mrs Linderman;
Thence through improved lands of Mrs Linderman N. 57 deg West
45 per to Pine Stump on wood lands of James Hepburn; Thence
through wood land of said Hepburn and also improved lands
of Henry Solada N. 47 deg. West 100 per. to line of lands claimed
by J. C. Rockey; Thence through clearing chopping of said
Rockey N. 65 deg. West 36 per to Maple stump; Thence South 85 deg
W. 25½ per to Public ~~road~~ just beyond a crossing of the B. R. & P.
Rail Road near Rockey's Sawmill a plot or draft whereof is
hereto annexed which road we report as Necessary and
further report no damages to accrue to } David Reams
any one except twenty-five Dollars to } J. P. Keyler
J. C. Rockey for making extra fence } J. Hamilton
May 1st 1891

} Viewers

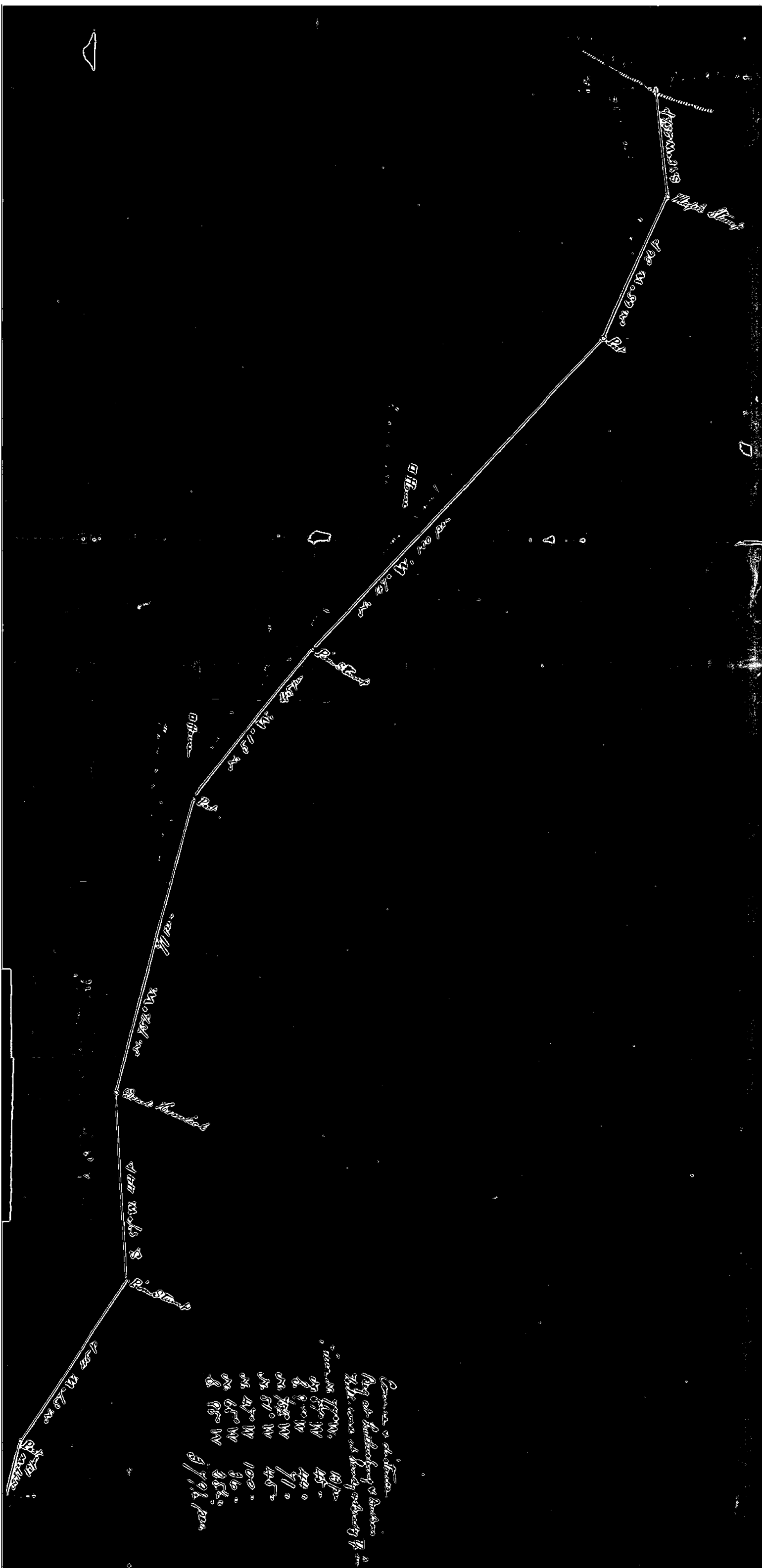

RULE TO TAKE DEPOSITIONS.

Clearfield County, ss:

Pepper Brawl

Jo

Samy Brawl

Quarter Term
In the Court of ~~Common Pleas~~
of Clearfield County, Pa.

No. *2* *Dec* *So. Term*, 1890.

And Now, to wit, the *13* day of *Dec*, in the year of our Lord one thousand eight hundred and ninety-~~00~~
the *Remarsons* enter a Rule to take the Depositions of ancient, infirm and going witnesses, to be read in evidence on the *argument* of this case. Ex parte Rule of *Remarsons* on *Feb* days' notice.

AM Blom
Clk

To *A. L. Gull*, Esq.:

Att for Remarsons

You will please take notice that, in pursuance of the foregoing Rule, depositions will be taken before *L. S. Hey*, or some other person authorized to administer an oath or affirmation in Pennsylvania, in and for the county of *Chapman*, at the office of *L. S. Hey* in the *Bar* of *Lewis*, in the county of *Chapman* and State of Pennsylvania, on the *14* day of *Nov*, A. D. 1891, between the hours of *9* o'clock *A*. M. and *9* o'clock *P*. M., when and where you may attend and cross-examine.

Clearfield, Pa.,

Oct 13

, 1891.

MC Dantz

Att for Remarsons

Served Nov 4 7

14, 1891

Nov 18 1891 it
to agree ~~with~~ ^{with} ~~the~~ ^{the}
Catholics of America
under this rule as
concerned to Nov 2/
1891. My point here
is that
any for Russia
at 1891

Depositions of witnesses produced, sworn, and examined before me, the 21st day of Nov, A.D. 1891, at my office in Kent Bais Ra, between the hours of 9 o'clock A.M. and 12 M., by virtue of the annexed Rule of Court of Quarter Sessions, and notice hereto attached, for the examination of witnesses in a certain cause pending in said court in the matter of a Public Road in Sandy Sp. Cefl Co Ra, - on the part of the Remonstrators.

Andrew Maloney, Sworn.

I am 38 years of age and live in Sandy Township Cefl Co Ra. I know there was a road laid out from Rocky's Mill to what is known as the Hill Road. I signed the petition for that road. Mr. Saluda said he had no road out, and he wanted it - I knew he wanted it and signed the petition. He didn't say much about the upper end - he said something about it but I can't recollect. Said he wanted a

road out through Mr. Peck's
farm to Peck's mill. It was
thoroughly dry but I saw
Peck & Mr. Anderson as
near as I can understand.
I don't see him for it is from
the road to the old road -
we never cut to the old road.
I don't think people would go
over the road crossing to Peck's
as near as I know, I found
I understand, I think it was
the further that way I have
been up through the bottom
where the road is - I marked
on Mr. Peck's farm first
above Peck's. The ground is
covered in the bottom, & the
road goes over the low ground
it would be expensive to
build.
Crossed -
I don't know where this
new road is laid out - I under-
stand it goes up that valley.
I don't know whether it is laid
on dry ground or swampy
ground. All that I know of

is his families living along
the line of it. They have no
public road out now at all.
If this road would come down
past Rinderman's and on the
right hand side of the Railroad
coming to Des Moines, I would
be in favor of it. The reason
why I would be in favor
of that road is because it would
accommodate the travelling
public.

Re-direct -

It would be an acc-
ommodation to have the road
on the right of railroad - though
they all have a road now. It
would benefit Miller & Kyser.
It would shorten my road.
It would give Mrs Salada
a road who now has only a
private alley. It would
shorten distance from the
old pike in. A private road
would benefit Salada and
Rinderman as much as a
public road. I suppose it is
Salada & Rinderman who are
accommodated by the new

Now I'd out. Don't think
I'd mind it at all.
Re-emo-
Other people may be
use it like Walter R. R. R.
man. I don't see that it would
help any other. I wouldn't
say that a good woman's there
for when I'm there. There's the
line on it. This road runs
between these water
between a great deal - the
River Road & the Old Road.
I don't say that a private road
would accommodate people
& R. R. R. as well as a
public road - they would
run to keep a private road
up at some expense. So go
to R. R. R. & would be
further in private road
than in the public road.
It would be near ~~to go to~~
R. R. R. & the present public
roads - than in the new road.
I'd had to take my choice
I would take the River Road
to go to R. R. R.

I think Rinderman & Salada
should have a road out.
This is as good a road for
them as they could have -
thru the road on the
right of Railroad would
accommodate others. We
could evade the wait at
the Railroad crossings.

a maloney

J. B. Rokey - sworn.

I lived in
Sandy Twp. until the 28 day
of April 1891. Am 54 yrs
of age. I have lived in Sandy
Township 10 years. at the
one terminus of this new road,
I am acquainted with the
line of this new road - was
with the viewers when it
was laid out. I have known
that ground where the road
runs thru for 10 years -
logged in that tract and
have been all over the land.
The ground this road runs
thru nearly entire length
is swampy, clayey, and of very
poor ground for building

[illegible]

run in a general direc-
tion with the old Hill
Road, at no distance ~~the~~
half mile from it - and
some places 60 rods.
It is 60 rods from the termi-
nus of this road where it
comes out from my mill-
to the terminus of the old
Hill Road, at the other end
it is not over 80 rods from
end of Hill Road. This road
would accommodate Rinder-
man & Salada in that neigh-
borhood only - but more
than I can tell how many
people it would accom-
modate, nothing in the
road to induce travel to
go over it. Not that I can
see would it shorten the
distance to places where
people would want to travel
to outside of for these ~~two~~.
Mr. Andrew Peitz owns all of
the land in this locality -
down to Mr. Rinderman and
it is woodland. On the
corner side I own all down

to the other road. On both
sides nobody is allowed
to enter on the north
side. Any body coming on either
of the roads leading out
of the town would have
no object in going out
the new road except to
get to either of the two
places (Lundholm or Rønde)
it would not shorten the
distance. People would not
travel the road coming
from Rønde through R. Rønde
in that direction, going to
Lundholm. It would make it
about a half a mile further
than coming in what is known
as Rønde Road. The consequence
of our this wish is
going every day
people who live on it would
lose the lower end of the
road. If during their lives
they at Lundholm, in my opinion
the road is not needed and
now for public use - their
particular have had an outlet

3

through my lot ever since
I have been there. They could
have a private road. It could
have been run so that it
would have injured the
adjoining parties much
less than at present and
it would benefit more
people. If they had staid
to view in Brady Co. near
Henry Peutz's land and
come down through there
on a nice grade which
they could along the side
Hill - past Salada's and
Kinderman's, to line between
Salada & myself, and Hyer
and Peutz, and then follow
the line down between Hyer
& Peutz to the Public Road,
it would have let Hyer out-
given better grade, better ma-
terial - & better road in every
respect to keep up. The par-
ties interested in the lands
were there the day of the view
and made a tender of the
lands to let them out in
that way. Sandy Lunsford

was a large amount of
Curtis Road. Over 100
feet in the St. Louis
river less than 10 miles
from the 20 mile, then
from the the shore
later 3 miles over the
river. I understand the
it is very much in debt
to the road fund. It is
up the road where it is
filled the machine for
repairing would have to be
run. The distance to
the road would depend
upon where they were
they it, I know that would
understand from the fact
the road from Chicago for
a public road.
crossed.

If they were would

the fact where somebody else

would it - the road was after
from Chicago, this road
was laid out over the ground
people have been travelling over
from the road since I know

lived there - some of it is so swampy that they wouldn't want to walk over it. I was along with the men. The men walked over this land. They didn't have any difficulty in getting along for the swamps. One mile of it is what I call swampy ground. This road is about 400 rods long. The road I propose would run over a part of this ground between Hinderman's Salada's - where there would be better grade and better materials. It would be probably about a ~~mile~~ quarter of a mile longer - yet Brady's, would run about half a mile of it - and it would cost less to build. The road I propose would be travelled a great deal more than the other. It would be more known than the other. It would let Kyer, Salada, Hinderman out. That road I propose would be about 80 rods - its terminus

from my mile, or the road
that the western side was
not over 60 rods I think. The
terminus at the other end
was at about 100 rods
from this road near the
last. This road of 100 rods
crossed the same road at
each end - as the one from
last out - by way of part
of an old road. It runs
down a part of the road
near last out. The old road
runs that runs parallel to
the road surveyed from first
it is an old road - but
cannot be recognized by being
filled up. The road is not so
close to the surface to have
made an old it probably
to have been laid down
road? are, I think it is -
know that they have been laid
over. With this - I cannot hope
wife. I never knew a woman like
to the same as I like
that back of them in the
Kendall County road up to the

There are a dozen or two of rods
on the road laid out that
would cost $\$25 =$ or $\$30$. They do
not haul heavy loads on
this road now - couldn't haul
an empty wagon on it. They
wanted him to fill 400 ft.
x 4 ft. high part of way - they
wanted him to do it to keep out
of swamps & over flow of the
water
J. C. Rocky

F. M. Shaffer sworn:

I live in
Sandy Sp. and am 25 yrs
old. My father is tp. Treasurer
of Sandy Sp. I do the business
for him. The Sp. is in debt at
 $\$4000$. - the road fund in judg-
ments & orders. Some of the judg-
ments have stood two years.
The largest - DuBois' judgment
since mch. no funds in the
hands of the Treas. to pay there
a few orders were issued this
summer. One to Resniger for
 $\$400$ - for bridge at Falls Creek -
borrowed money. The rate of mills

the Road that has been 10-
five years has been 20 miles
of them. They look 3 leagues
across the way. I was
along when the upper part
of the road from Berkeley's
house to Indio. It has been
the Road was named. I had
in when 30 miles are good
ground along the hills
next to Berkeley - 20 miles
and now along a spring with
springs it is dirt running
where the road runs exactly
from Berkeley down to the
hill that the flat from Berkeley
has been down to the mile
is not a fairly good
I have gone over it and
found it wet Berkeley
I worked on the mile and
up stream this way. I
would think it would
be quite an expense to build
it. It would have to be
constructed or handled
along the road. I have
think. It is not far from

the old Hill Road, that has
been opened for years - not
over $\frac{1}{4}$ mile. If it were clear-
ed of woodland, this old
road could be seen most
of the way from the new
one. The terminus of this new
road, on the road from
Jeff. Run to Deer Run, is
about $\frac{1}{4}$ mile from the
terminus of the old road
at the school house. The
other terminus of new road -
is about same difference
from other end of the Hill
Road. I don't think there is
any public necessity for
this new road - don't think
there is. People have a
better road to travel by com-
ing the Turner Road, no use
to anyone except Salada
& Tinderman - no benefit
to public. They have no road,
Salada & Tinderman could get
a private or a public road
at less expense in my judgment.
They could come out on the line
between Peaty & Shaffer over a

cannot agree to the old will.
 Dead. It would be the same then
 except where they would have
 to own the same and then
 they would need a bridge.
 I think it would be easier to
 build that up a road that
 from Beladon and across
 the hill to come out at the
 end of St. Peter's Lane, my
 father has agreed then ground
 from Beladon's Lane out to
 the Hill Road on the side
 I agree at. It would be
 better for people coming
 from Beladon to go
 down the new road in
 going to Beladon - then
 go to the old road, bringing
 them road they would not
 think of leaving the new
 road. The road would
 be covered in only four
 people to go to Beladon and
 Beladon for them to get
 out.

Croydon:-

the road and bridge

to Pentz's lane would be
steeper than this one. all I
know of the road is that it is
swamp except 30 rods at
upper end. It is spunky ground
Clear to the Ridge. From Salada's
to the Mill the swamp is about
95 or 20 rods wide. One side
of run it is about 10
rods wide. Rocker has
used it for pasture. The swamp
is swampy about 25 or 30
rods wide. I have travelled
through there a hundred
times at least. As a rule I went
through this swamp to work.
No swamp on the old Hill
Road - but about 150 ft. it
is filled near Railroad. It
isn't a ~~quarter~~ half a mile - but
more than a quarter from
Rocker's Mill to the Old Hill
Road. The old Hill Road is pretty
steep. I don't think it too steep
to haul loads on. Lots of sleeper
ties in it. Could we make better
by doing the work on it. I don't think
the public would use that road -
unless the Camer Road would

the two models. They would
use it I mean in carrying
to Benbow. They would
it in going from Benbow to
Antikony. It is going from
mainly at Benbow's
to Mr. Bell - it would be
us near to go the Old Well
Road. I don't know much about
out of thinking in keeping up
road.

Revised:

Nothing on this road,
to know any one go this road,
unless they are going to Benbow
thence or to Hyer, Beala, or
Antikony.

F.M. Bell

Andrew Bell, Dr. Brown:-

more than

one-third - or about 200 rods
of this road runs through my
land. I was not with the surveyor,
but there is an old road parallel
to this road - Benbow out about
50 yds. ago - the Old Well Road.
The Old Well Road from my place.

out to the pike was laid out
before I came here. This new
road runs parallel to the
Old Hill Road except where
crops & turns are. Its about
60 rods from Rockey's mill
to the Old Hill Road at School
House. It is about a quarter of
a mile from this new road
to the Rockey's mill to where
old Hill Road comes out at
School House. ~~Where~~ This
road runs 145 rods through
my land from Rinderman's
line to the Brady Sp. line.
At Rinderman's line it is about
40 rods distant from to the
Southwest corner of my
land. It is about two-to
three rods at the upper end
on the Brady line. From
Brady line down to Rinder-
man's it goes as, I tried to
follow it & could not. It requires
time by cutting off a piece
& making it worth nothing
for farm purposes. A good
bit of ground over my land
through which it runs is

they were of course fallen all
as far as they were fallen all
it was down fallen nations
an one rise from nations with
other, I think they came from
made this road a little shorter,
and little better at upper end
I don't know whether they came
from made it was better or
were they from, they from
again it is probably, it, about
the width of the road if they
had cut it to a little com-
ing up it would be the
likely, in my lower level
they don't they mean between me
and Rocky about 50 rods,
that ground across the distance
the ground for a road, it might
do, they probably is that nature
gravel it and nobody wants it,
as for a general public to com-
eased, I have made nothing
people who live near the
upper end of the road, they don't
want it, I have made nothing
I think the upper end of this

road. I offered them a half
a road from Harry Salada's
corner out along Myers Run
to the Ridge Road, & also half
the road on either side between
me and Rokey - on condition
that if they make private
road I may use it free of
toll. These people could get
along with a private road.
It wouldn't be very expensive to
keep up a private road there.
No neighbor wants them hemmed
in - but object to a public road.
Arthur Perry, ^{Secy}

I hereby certify that the above
witnesses were duly qualified and
examined at the time & place
stated in the above caption, and
subscribed their depositions in
my presence.

Herbert A. Moore,
Notary Public.

LAP-OVER MARGIN

PAID
no. 3 rec'd 1890

Cuba's Road
du
Study Journals

depositions.

Costs \$10.00

HERBERT A. MOORE,
Attorney at Law,
DU BOIS, PA.

John C. Clark & Sons, 420 Dock Street, Philadelphia.

To the Honorable D. L. Krebs President Judge
of the Court of Common Pleas & Quarter Sessions
of Clearfield County.

The petition of the undersigned citizens
of Sandy Township and vicinity respectfully
represent that they labor under great
inconvenience for want of a public road
starting at what is known as Rockers Run
mill on the Dr. Boiss & Suthersburgh road
and ending at or near the oak timber
on the lands of Anselmo Pütz Sr.

They therefore pray that viewers be appointed
according to law to view said premises
and make report thereof to the next Term,
& they will ever pray &c.

Henry Salada

W. L. Dunlap

J. L. Dunlap

Frank Walburn

Henry Walburn

S. H. W. Bell

Simon Walburn

David Walburn

D. A. Kessler

J. A. Lyons

James Hard

W. H. Lyons

J. J. Wallace

A. Malone

J. J. Grier

J. J. Wilson

George C. Lindeman

No 3 Dec 1890

Petition for Public Road

ⁱⁿ
Sandy Township
leading from Rockers
Mill to A. Putz - St.

Now 1st Dec. 1890 the
within petition presented
and considered
and thereupon, Durand, Reamy,
J. P. Taylor, - J. Hamilton, are
appointed to view
the premises and make
report to next Term, ac-
cording to law.

By the Court
D. C. Krebs

Filed 31 Dec 1890

C + M 2

To the Honorable, the President Judge of the Court of Quarter Sessions of Clearfield County.

We, the undersigned, citizens and taxpayers of Sandy Township, in said County, respectfully remonstrate against the confirmation of the public road recently laid out in said Township to No. February Sessions 1891, leading from at or near Rockys Mill in said Township, to the public road leading from DuBois to Goodlanders at a point at or near the line of A. Pentz, Sr. and Peter R. Singer, for the following reasons.

First. Said road is not needed for public travel, as another public road that has been in use for nearly fifty years parallels it and at no point is one half mile distant from said road. Said road has been laid out to accommodate but two families and these parties can be accommodated by a private road, and at various times have been offered the land over which to make a road for themselves free of charge, which would make a great deal better road than the one laid out in this case.

Second. Said road is laid out through low swampy ground and over land where no material can be found to build a road unless it is hauled for some distance, and the costs of the opening of this road would be very large and burdensome to the tax payers of said Township and after it is built it would be very expensive to keep in repair.

Third. What is known as the upper end of this road would not be traveled by any one scarcely, and that end of the road was tacked onto what is known as the lower end of the road for the purpose of getting a public road and not for the reason that it is needed to accommodate the traveling public.

Fourth. The present debt of Sandy Township is large and the taxes are levied up to the full limit of ten mills to keep in repair what roads are now open and used in said Township, and last year twenty mills tax was assessed
XXXXXX

John B. Williams John ^{Pro} Williams
G. W. Smith Thomas Williams
John Vaskinder Robert J. Kirtley

George L. Farmer
William Moorhead John L. Farmer
Sworn Wilson Eliza Washburn
John Alberg Thomas Watkinson
George Kirtley
Peter Nelson
Ole L. L. L.

James Walker
Thomas Walker
William Phipps
A. E. Martin
Mr John Fudge
Mr Edward Whitehouse
Gust Larson
Charles L. Larson
S. J. Williams
David Hill

J. W. Squire
B. J. Williams
David Meehan
Robt Strawbridge
James C. Davis
George Brown
Christopher Barass

To the Honorable the Judge of the Court of Quarter Sessions of Clearfield County.

We, the undersigned citizens and tax payers of Sandy Township in said County, respectfully remonstrate against the confirmation and laying out of a public road reported to No. Feb. Sessions 1891 in said Township, for the following reasons.

First. Said road is not needed for public travel, as another public road that has been in use for nearly fifty years parallels it and at no place is one half mile distant therefrom. Said road has been laid out to accomodate but two families and these parties can be accomodated by a private road and at various time have been offered the land over which to build a road for themselves free of charge, which would make a better road than the one laid out by the viewers in this case.

Second. Said road is laid out through low swampy ground and over land where no material can be found to build a road unless it is hauled from a distance, and the cost of opening this road would be very large and burdensome to the tax payers of said Township, and it would be an expensive road to keep up after it is built.

Third. What is known as the upper end of this road would not be used by any one scarcely and was only tacked onto the lower end for the purpose of getting a public road, and not for the reason that it is needed for public travel.

Fourth. The present debt of Sandy Township is large and the taxes are high, being levied up to ten mills the full limit allowed by law, and in 1890 the road tax levied and collected was twenty mills for the purpose of repairing the roads already laid out and opened, and to open any more roads in said township would be very burdensome to the people and would be hard to keep in repair.

No disconnections
to Brady, C. L. & Co.

Chairs of
Sandy, E. R.

John Clapton

John Lankard

J. H. Penby

Samuel Postlethwaite
Samuel Postlethwaite Jr

C. H. Suckman

W. C. Linger

Henry Ditzinger

W. H. Reasinger

J. B. Passmore

W. Bogle

W. C. Linger

Edwin Liddle

Charles Abner

Lincoln Anthersbaugh

Gabe H. H. H.

Andrew Liddle

Gabe H. H. H.

Joseph Miller

W. H. Linger

E. W. Heberling

A. Heberling

J. F. Heberling

A. S. Wall

John Heberling

No. 3 Dec 25. 1878
On R. Road in
Lundy P. M.

Remembrance

This is caught 1878

Only

To the Honorable the Judge of the Court of Quarter Sessions of Clearfield County.

We, the undersigned, citizens and tax payers of Sandy Township in said County, respectfully remonstrate against the confirmation and laying out of a public road in said Township, to No. February Sessions 1891, leading from a point at or near Rockys Mild to a public road leading from DuBois to Goodlanders, at a point at or near the line of Andrew Pentz, Sr. and Peter Resinger, for the following reasons:

First. Said road is not need for public teavel, as another public road that has been in use for nearln fifty years parallels it and at no point is a half mile distant therefrom. Said road has been laid out to accomodate but two families and these parties can be accomodated by a private road and at various times have been offered the land over which to make a road for themselves free of charge, which would make a great deal better road than the one laid out by the viewers in this case.

Second. Said road is laid out thsough low swampy ground and over land where no material can be found to build a road unless it is hauled for some distance, and the costs of opening this road would be very large and burdensome to the tax payers o said Township, and it would be an expensive road to keep in repair after it is built

Third. What is known as the spper end of said road would not be traveled scarcely by any one, and that end of the road was tacked onto the the lower end for the purpose of getting a public road, and not for th e reason that it is needed for public travel.

Fourth. The present debt of said Sandy Township is large and the taxes are high being levied up to ten mills the full limit allowed by law to keep in repair the roads already laid out and opened and during the year 1890 the road tax levied and collected was twenty mills, for the purpose of keeping up and repairing the roads of said township

Al Fozier

John Lankard

J M Askey

Saml Postlethwaite

Amos Kline

J D Seiler

A. Mitchell

Michael Krasinger

Geo. W. Phipps

S. H. W. Bell

M. S. Hamlin

V. H. Sheffer

Joseph L. L.

Joe Maloney

Ms acc 58189

Remembrance &

Revelin Sirey

of my drawing from

Revelin Sirey

is back of rest

Ms 9 Sept 1891