

No. 2

Sept

Term, 1893

Vacate & Supply
Public Road

Versus

Bigler Township

Contents:

X

RELEASE OF DAMAGES.

Know All Men by these Presents, That we, the undersigned, owners of lands through which the road located by the viewers, under the annexed order, passes for and in consideration of the sum of ONE DOLLAR to us respectively paid by the at and before the ensealing and delivery hereof, have remised, released and forever quit-claimed; and do hereby remise, release and forever quit-claim to the said all damages that may arise to us respectively by reason of the location and opening of the said road, so that neither we nor any of us, nor any person claiming under us, can or may hereafter ask, sue for, demand, have or recieve any damages for injuries arising or growing out of the location and opening of the road aforesaid.

Witness our hands and seals this day of
A. D. 189 .

Seal

Seal

Seal

Seal

ASSESTMENT OF DAMAGES.

The following persons, having refused to release the damages to which they respectively may be entitled by reason of the location and the opening of the said road in the annexed return described, we, the undersigned viewers, under oath in pursuance of our duty, under the Act of Assembly, do assess their damages and make report thereof, as follows :

To the sum of

To the sum of

To the sum of

Witness our hands this day of, A D. 189 .

Clearfield County, ss:

At a Court of Quarter Sessions of the Peace of the county of Clearfield, Pennsylvania, held at Clearfield, in and for said county, on the Fourth day of September, A. D. 1893, before Judge of said Court, upon a petition of sundry inhabitants of the township of Bigler, in said County, setting forth that

That that portion of the Public Turnp road leading from Banion to Madera Beginning at a point at the line of J. H. Shoff on said road to a point where said road intersects a road leading from Houtzdale to Glen Hope has become useless dangerous and burdensome to the Citizens of the Turnp

That a new safer and better road could be laid out to supply the place of the old road

Therefore pray the Court to appoint Viewers to view and lay out such a road Beginning at a point on the aforesaid Turnp road at the line of J. H. Shoff and ending at a point of Intersection with the road leading from Houtzdale to Glen Hope at the North western corner of the Madera Hotel and therefore praying the Court to appoint proper persons to view and lay out the same according to law, and make Report to the Court

whereupon the Court upon due consideration had of the premises, do order and appoint Asa Spencer Wm Ricard and Robert McManara who, after being respectively sworn or affirmed to perform the duties of their appointment with impartiality and fidelity, are to view the grounds proposed for said road, and if they view the same and any two of the actual viewers agree that there is occasion for such road, they shall proceed to lay out the same agreeable to the desire of the petitioners, as may be, having respect to the best ground for a road and the shortest distance, and in such manner as to do the least injury to private property, and state particularly, whether they judge the same necessary for a PUBLIC or PRIVATE road, together with a plot or draft of the same, with the courses and distances and reference to the improvements through which it passes, and shall also procure releases of damages from persons through whose land said road may pass, or failing to procure such releases, shall assess the same, if any sustained, and shall make report thereof to the next Court of Quarter Sessions to be held for said county, in which report they shall state that they have been sworn and affirmed according to law, Notice is directed to be given to the owners or occupants of seated land through which the within road is intended to pass, of the time of the view, according to the 147th Rule of Court.

BY THE COURT.

D. J. Gury

CLERK.

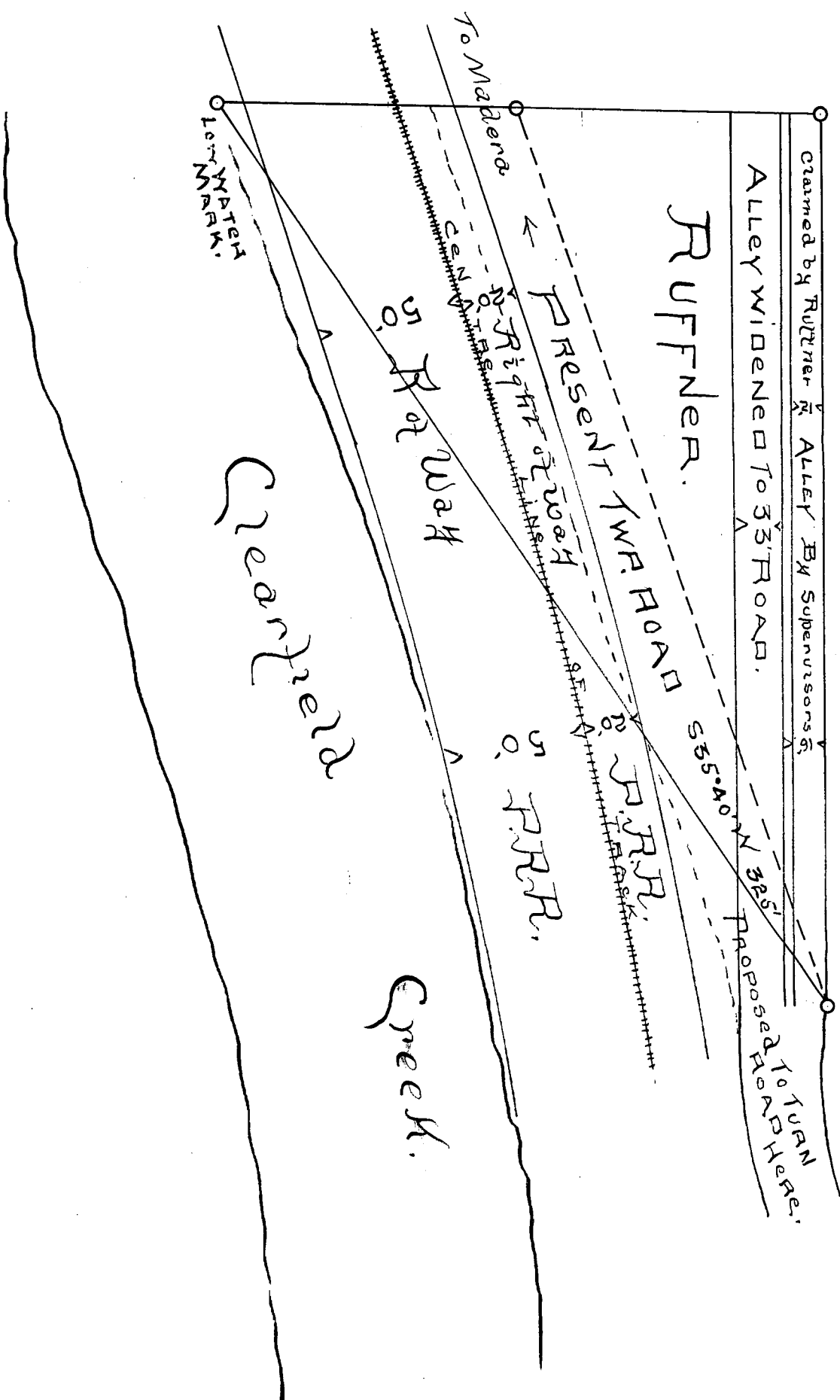

00 00 00 00 00 00

I the Honorable the Court within mentioned; we the undersigned viewers appointed to ^{and supply} vacate the road within mentioned. Report that in pursuance of said order, having been severally sworn as here in directed and after the accustomed ten days notice and notice having been given County Commissioners as required by rule of Court we have viewed the road and in our judgment believe the old road to be entirely sufficient for the needs of all as a public road. [the same beginning at a point on the line of J. W. Shoff on the Dwp. Road from Sanion & Madera thence S 30° 40' W - 32 feet to point in Dwp road from Stonydale & Glen Hope] for the reason that the Pennsylvania Railroad Co. has purchased forty feet of ground from Peter Ruffner giving twenty to the Dwp for road and ~~keeping~~ twenty for Right of Way the granting the use of ten feet of said Right of Way if necessary (which it is not) the road being ample width and the expense great in changing same. We therefore Report that in our opinion the change is ^{unnecessary} ~~unnecessary~~.

Asa Spencer
William Pickard
J. H. McNamee

2 Sep Sessions, 1893
No.

ORDER

Locate Supply

To view and lay out a road for

Public use in the township of

Pigler, Clearfield Co.

Dec 2 Sessions, 1893,

~~read and confirmed N. B.~~

Road to be opened 33 feet

wide, except where there is

side hill cutting or embank-

ment and bridging, there to

be 16 feet wide.

By the Court

Filed. H. L. Oell, 1893

Fees \$1.25, paid by W. Patterson

Patterson

NOTE:—In case of a private road, the release must be executed in favor of the petitioner for said road.

Also—Viewers will carefully note the number of days employed, and set the amount out at the foot of their return.

Reviewers cannot interfere with damages assessed by the original viewers, except so far as the location may be changed by the reviewers.

N. B.—If the viewers believe the parties are not entitled to damages, taking into consideration the advantages as well as the disadvantages of the road, they will report to that effect.

		AMOUNT.
As Viewers } (1432)	Days 2	1000
	Miles	48
Wm. Pagan } (1433)	Days 1	200
	Miles	44
R. H. McFarlane } (1434)	Days 1	200
	Miles	48
	Days	
	Miles	
	Days	
	Miles	

To the Honorable David L. Krebs, President Judge of
Clearfield County, Pennsylvania.

The petition of the undersigned citizens and tax-payers of
Bigler Township, respectfully represent,

That that portion of the Public Township road leading from
Danion to Madera, beginning at a point at the line of *J. W. Shoff*
on said road to a point where said road intersects a road lead-
ing from Houtzdale to Glen Hope, has become useless, dangerous,
and burdensome to the citizens of the Township,

That a new, safer, and better road could be laid out to supply
the place of the old road,.

Your petitioners therefore pray your Honorable Court to ap-
point viewers to view and lay out such a road beginning at a
point on the aforesaid township road, at the line of *J. W. Shoff*,
and ending at a point of intersection with the road leading from
Houtzdale to Glen Hope, at the north-western corner of the Made-
ra Hotel.

And your petitioners will ever pray.

Names	Residences
<i>Nicholas Fry</i>	<i>Madera</i>
<i>J. W. Shoff</i>	" "
<i>W. J. Meurer</i>	" "
<i>James O'Leary</i>	<i>Madera Pa</i>
<i>C. C. Ball</i>	<i>Smock, Pa</i>
<i>W. R. Dr. ...</i>	" "
<i>P. S. Ball</i>	" "
<i>John Beyer</i>	<i>Madera</i>

Names	Residences
Lew W. Beyer	Madera Puma
W. P. Connelley	" "
G. B. Curry	" "
L. J. Hagan	" "
J. J. D. ...	" "
J. J. ...	" "
E. Miles	" "
F. B. ...	Green Hope
H. F. Dale	Madera, Pa.
A. C. Short	" "
H. A. Davis	Bilsema Mills Pa
B. Bosworth	Madera
Mrs D. Whiteside	" "
Hans Lueen	" "
James S. ...	" "
P. B. Schopf	" "
James ...	" "
H. J. Schopf	" "
E. Lark Hilman	" "
A. D. Schopf	" "
A. C. Hilman	" "
W. B. Speise	" "
W. J. ...	Madera
J. A. ...	" "
J. H. Smith	" "

Names	Residence
James Kaul	Madera pa
Thos Blyth	" "
" "	" "
Samuel Whitgirdle	" "
Geo H Moore	" "
Gust Johnson	" "
J. G. Jacob. Reed	" "
D. D. Henderson	" "
Jerry Hegarty	" "
Darfield Hegarty	" "
James Lyther	" "
E. R. Miles	Madera pa
James Corneby	" "
J. F. Corneby	" "
Chas. G. Hill	" "
Linton Beeman	" "
John, D. Householder	Madera pa
Bag Whiteside	
John Whiteside	
Samuel Richards	
W. D. Hyskell	
H. P. R. Bland	
L. B. Bepko	
Reuben Hegarty	
J. T. Wilson	

No 2 Sep 88 1893

Petition of Citizens of
Rapid Camp to Burn and
Locate and complete a
portion of a Southern Road
in Rapid Camp beginning
at a point on Camp Road
near line of N. of W. of N. and
ending at a point on Camp
Road ending from the place
to the creek at the mouth
of the creek of the Rapid
Creek

Where the N. of W. of N. of N. 1893
the northern portion road
in Rapid Camp and upon
an agreement of the
same. At the same time,

Wm. Ricard and Robt

McMannara-

are appointed to burn
and locate. They will complete
a road in Rapid Camp
from

By Wm. Ricard

Recd 4 Sep 88 1893

of Rapid Camp

Wm. Ricard