

No.

8 May

Term, 1901

Vacated Supply  
Public Road

versus in

Lawrence Township

Laid out to No 7 Sept 22 1899

R.S. #4 - Page 335

Part map No 457

K and L

Nov 13 1901

This is to certify that the  
Township road leading from  
C. Mc Anderson to Joseph Foster  
is now to the Public for traveling  
in Lawrence Township

Superior

Harold Bond

Superior

L. G.

8 May Dec 1901

FILED

JAN 2 1902

Grant H. Thompson,  
Prothonotary.

GRANT H. THOMPSON,  
Prothonotary and Clerk of Court.

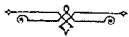

CLEARFIELD, PA.,

Dec. 14 1901

To Grant H. Thompson

I hereby certify that Road  
No 8 May ss. 1901. leading from  
the house of Joseph Foster, leading from  
Oshanter to Alanta to a point on Public  
Road leading from Morgans to Jas. A. Reeds  
near the house of A. M. Anderson, has  
been opened for Public use

Joseph L. Bess  
Supervisor L. G.

No 8 May Dec 1901  
Doak

FILED  
DEC 14 1901  
Grant H. Thompson,  
Prothonotary.

To the Honorable the Judge of the District Court of Cleopatra Co.  
Pa.

The undersigned Citizens of Lawrence Twp. Cleopatra Co. Pa. Respectfully Represent that a public Road was laid out to N<sup>o</sup> 7 September 1899 from a point on public road near the house of Joseph Porter, leaving from Othaula to Olanta, to a point in public road leaving from Morgan to J. S. Reed, near the house of Am Anderson. That said road has been opened in part; That your petitioners now pray your Honorable Court to appoint viewers to view and locate so much of said road as follows viz. 1<sup>st</sup> that part not opened where the same crosses the property of Joseph Porter and supply the same by a road beginning at a point about 25 or 30 feet from the point where the said road enters the public Road leading to Othaula from Olanta, and thence by new route to strike said public Road near the western line of Joseph Porter. 2<sup>d</sup> to locate so much of said road laid out beginning at a point in said road south of the line of Edward Swartsworth; thence by the nearest and best route to a point in the road leading from Reed to Morgan above near where the land line between Edwin Swartsworth and Anderson touches said Reed and Morgan Road, and to make report to your Honorable Court at the next term. All of which is Respectfully submitted.

Edmund Bauman

Ed. Johnson

Andrew Garrison

Anderson, A. Lind

Gas Norman

Abraham Enloe

Joseph Foster

Thomas Thomas  
John J. Thomas  
S. M. Bloom

John Black  
Hugh Collins  
Hugh McAttee

L. P. Rowles  
Calvin Rowles

P. S. Rowles

John Kirkwood

John Wilson

E. C. Lewis  
Paul Bonst  
C. B. Diller

James White

Jas. J. Read

Hugh Kline

Wood J. Williams

John Rowles  
A. S. Hutchinson

Thomas Fisher

No 8 May Dec 1901

Petition to vacate and  
supply parts of Rona land  
out to N<sup>o</sup> 7 Sept Dec 1879

Lawrence Township

Ans now H McPherson 1901

Petition read and thereupon  
Alley Carter, Edward Horner and  
Henry Rogers, appointed to view  
and locate and supply and make  
return of May Dec 1901

By the Court  
Cyrus Embury

*per*

FILED

MAR 4 1901

Grant H. Thompson,



Clearfield County, ss:

At a Court of Quarter Sessions of the Peace of the county of Clearfield, Pennsylvania, held at Clearfield, in and for said county, on the 4<sup>th</sup> day of March, A. D. 1901, before the Judge of said Court, upon a petition of sundry inhabitants of the township of Lawrence

\_\_\_\_\_ , in said county, setting forth that a public road was laid out to No. 7 Sept. 28 1899 from a point on public road near the house of Joseph Foster leading from Oshanta to Clanta to a point in public road leading from Morgans to Jos. A. Reeds near the house of A. M. Andersons. That said road has been open in part. That your petitioners now pray your Honorable Court to appoint viewers to review<sup>ed</sup> and vacate so much of said road as follows, viz. 1<sup>st</sup> that part not opened where the same crosses the property of Joseph Foster<sup>ed</sup> supply the same by a road beginning at a point about 25.2 perches from the point where the said road enters the public road leading from Oshanta to Clanta. Thence by new route to strike said public road near the Western line of Joseph Foster. 2<sup>nd</sup> to vacate so much of said road laid out, beginning at a point in said road south of the line of Edward Swateworth. Thence by nearest<sup>ed</sup> best route to a point in the road leading from Reeds to Morgans at or near where the land line between Swateworth<sup>ed</sup> and Anderson to the said Reeds and Morgans Road. and therefore praying the Court to appoint proper persons to view<sup>ed</sup> and vacate<sup>ed</sup> and supply the same according to law, and Report to next term whereupon the Court, upon due consideration had of the premises, do order and appoint Harry Byers, Alex. Antes, and Edward Hoover who, after being respectively sworn or affirmed to perform the duties of their appointment with impartiality and fidelity, are to view the grounds proposed for said road, and if they view the same and any two of the actual viewers agree that there is occasion for such road, they shall proceed to vacate<sup>ed</sup> and supply agreeable to the desire of the petitioners, as may be, having respect to the best ground for a road and the shortest distance, and in such manner as to do the least injury to private property, and state particularly, whether they judge the same necessary for a PUBLIC or PRIVATE road, together with a plot or draft of the same, with the courses and distances and reference to the improvements through which it passes, and shall also procure releases of damages from persons through whose land said road may pass, or failing to procure such releases, shall assess the same, if any sustained, and shall make report thereof to the next Court of Quarter Sessions to be held for said county, in which report they shall state that they have been sworn and affirmed according to law. Notice is directed to be given to the owners or occupants of seated land through which the within road is intended to pass, of the time of the view, according to the 147th Rule of Court.

BY THE COURT.

Grant H. Thompson  
Clerk.

## RELEASE OF DAMAGES.

Know all Men by these Presents, That we, the undersigned owners of lands through which the road located by the viewers, under the annexed order, passes for and in consideration of the sum of ONE DOLLAR to us respectively paid by the ..... at and before the enrolling and delivery hereof, have remised, released and forever quit-claimed; and do hereby remise, release and forever quit-claim to the said ..... all damages that may arise to us respectively by reason of the location and opening of the said road, so that neither we nor any of us, nor any person claiming under us, can or may hereafter ask, sue for, demand, have or receive any damages for injuries arising or growing out of the location and opening of the road aforesaid.

Witness our hands and seals this ..... day of .....  
A. D. 190.....

Seal

Seal

Seal

Seal



## ASSESSMENT OF DAMAGES.

The following persons, having refused to release the damages to which they respectively may be entitled by reason of the location and the opening of the said road in the annexed return described, we, the undersigned viewers, under oath in pursuance of our duty, under the Act of Assembly, do assess their damages and make report thereof, as follows:

To Joseph Foster the sum of Thirty Dollars  
To A. M. Anderson the sum of Fifty Dollars  
To Edward Swatworth the sum of ten dollars  
to James S. Reed nothing  
to Zona Bowman estate nothing  
Witness our hands this 21<sup>st</sup> day of March A. D. 1901.

J. A. Artes  
E. J. Hoover  
Harry Byers

# Road Viewers' Notice.

NOTICE IS HEREBY GIVEN that the undersigned Viewers, appointed by the Court of Quarter Sessions of Clearfield county, Pennsylvania, to view <sup>Public</sup> ~~Vacate & Supply~~ Road leading from

~~point on public road near house of Jos. Foster leading from Oshanter to Olanta to a point in public road leading from Morgan's to Joseph A. Reed's near the house of A.M. Anderson partly opened, as follows: First that part not opened where the same crosses the property of Jos. Foster, and supply the same by a road beginning at about 25.2 perches from the point where the said road enters the public road leading from Oshanter to Olanta; thence by new route to strike said public road near the Western line of Joseph Foster; second, to vacate so much of said road laid out, beginning at a point in said road South of the line of Edward Swatsworth; thence by nearest and best route to a point in the road leading from Reeds' and to Morgans' at or near where the land line between Swatsworth's and Anderson's touches the said Reed and Morgan Road.~~

in Lawrence Township, in the county  
aforesaid, will meet at the house of Joseph Foster  
, in Lawrence

Township, on Thursday, the twenty-first  
day of March, A. D. 1901, at 1 o'clock  
P. M., to attend to the duty assigned them,  
of which time and place aforesaid all parties  
interested will please take notice.

Harry Byers.

Alex. Antes.

Edward Hoover.

Viewers.

Clearfield, Pa., March 11, 1901.

Served on us this  
12th day of March 1901

C. T. Davis  
C. T.

# Road Viewers' Notice.

**NOTICE IS HEREBY GIVEN** that the undersigned Viewers, appointed by the Court of Quarter Sessions of Clearfield county, Pennsylvania, to view <sup>Public</sup> ~~vacate & supply~~ **Road leading from**

~~point on public road near house of Jos. Foster leading from Oshanter to Olanta to a point in public road leading from Morgan's to Jos. A. Reed's near the house of A. M. Anderson, partly opened as follows: First, that part not opened where the same crosses the property of Jos. Foster and supply the same by a road beginning at about 25.2 perches from the point where the said road enters the public road leading from Oshanter to Olanta, thence by new route to strike said public road near the Western line of Jos. Foster; second, to vacate so much of said road laid out, beginning at a point in said road South of the line of Edward Swatsworth, thence by nearest and best route to a point in the road leading from Reed's to Morgan's at or near where the land line between Swatsworth's and Anderson's touches the said Reed and Morgan Road.~~

in Lawrence Township, in the county  
aforesaid, will meet at the house of Joseph Foster

, in Lawrence  
Township, on Thursday, the twenty-first  
day of March, A. D. 190<sub>1</sub>, at 1 o'clock  
P. M., to attend to the duty assigned them,  
of which time and place aforesaid all parties  
interested will please take notice.

Harry Byers.

Alex. Antes.

Edward Hoover.

Viewers.

Clearfield, Pa., 2 March 11th, 190<sub>1</sub>.

Lived on us this  
15th day of March

A.D. 1901

Deer' Pawles { Supervisors  
Joseph Board of Lawrence  
Township

x

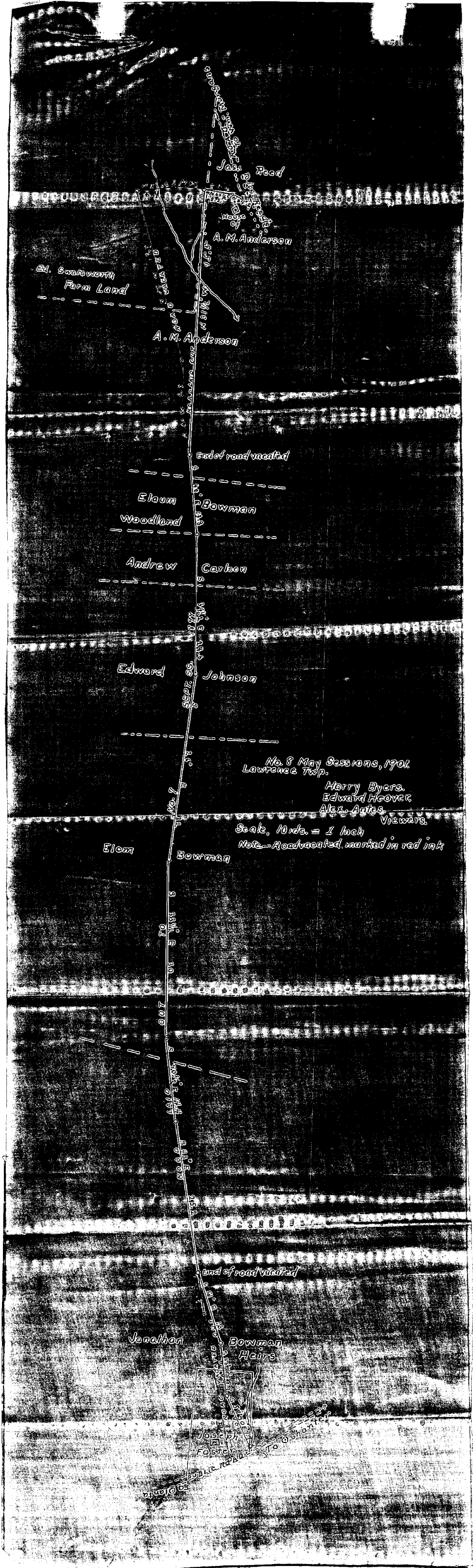

To The Honorable Cyrus Gordon President Judge of the  
Court of Quarter Sessions of Clearfield County Pa we the  
undersigned viewers appointed by the within order of court  
to view and vacate ~~and~~ supply the parts of the road therein  
mentioned, respectfully report that we gave good and lawful  
notice of the said roadview with notice to County Commissioners and  
supervisors of Lawrence Township and was agreeable to the said  
notices and having been severally sworn or affirmed we  
viewed the road proposed for vacation and supply, and have vacated  
and supplied the same as follows; ~~that on~~ the road to no 7 Sept 55 1899, at  
that part of said road not opened, through land of Jonathan Bowman Estate  
and Joseph Foster beginning Thirty Three rods from where said road enters  
road from Ashanter to Clauta thence South forty three degrees East seven and  
eight tenth perches thence South forty four degrees East twenty  
five and two tenth perches crossing property of Jonathan Bowman Estate  
and Joseph Foster to road leading from Ashanter to Clauta at point  
near house of Joseph Foster which part above described of no 7 Sept 55  
1899 is useless inconvenient and burdensome and should therefore be va-  
cated, and to supply the same we have laid out and do return for pub-  
lic use the following road to wit: beginning at a point about 252 perches  
or more exactly Thirty Three perches from where road to no 7 Sept 55 1899 enters  
road leading from Ashanter to Clauta thence through wooded land of Jona-  
than Bowman thence South fifty one degree East thirteen perches to a  
post thence through same and improved land of Joseph Foster South forty six  
degrees thirty minutes East eight and nine tenth perches to a post  
thence through improved land of Joseph Foster aforesaid South fifty eight de-  
grees thirty minutes East nine and seven tenth perches to post at  
road leading from Ashanter to Clauta thence by the said road to the western  
line of Joseph Foster aforesaid, which road as laid out is necessary  
in our opinion for a public road; 2nd that part of road laid out to no 1 Sept  
55 1899 to wit: beginning on land of A. M. Anderson South of Edward Swate-  
worths line thence North forty degrees West through improved land of A. M.  
Anderson sixteen and three tenth perches thence through same and land of  
Edward Swateworth North fifty degrees West twenty nine and nine tenth per-  
ches thence through improved land of Edward Swateworth aforesaid North  
forty eight degrees thirty minutes East six and four tenth perches, thence  
North fifty degrees East through same and on line between land of James S  
Reed and A. M. Anderson aforesaid twelve and three tenth perches to road  
leading from Morgans to Joe A. Reeds, is useless inconvenient and bur-  
densome and should therefore be vacated, and to supply same we have laid out  
and do return for public use the following road to wit: beginning where the post va-  
cated begins thence through improved land of A. M. Anderson and Edward Swateworth  
North thirty one and one half degrees West forty five and five tenth perches to a post  
thence through land of Edward Swateworth, James S. Reed and A. M. Anderson  
North sixty three and one half degrees East five and two tenth perches to a  
post thence through land of Joe S. Reed and A. M. Anderson North eighty four de-  
grees East two perches to road leading from Morgans to Reeds thence  
by the said road to where property line between Swateworths and Reeds  
touches the said Morgan Reed road, which road as laid out is necessary  
in our opinion for a public road. A plot or draft of roads as laid out to  
no 7 Sept 55 1899 and roads as laid out and vacated by us, with the improve-  
ments is herewith annexed. Witness our hands this twenty  
first day of March A.D. 1901

J. A. Antler  
E. J. Hoover  
Harry Byers  
viewers



No. 8 May Sessions, 1901

## ORDER

To view, ~~investigate~~ *survey*  
road for *public* use in the  
township of Lawrence,  
Clearfield County

13 Macysons, 1901,  
read and confirmed N. S.  
Road to be opened 33 feet  
wide, except where there is  
side hill cutting or embank-  
ment and bridging, there to  
be 16 feet wide.

*By the Court*  
*E. W. Gordon*

*M*

Filed 1901

Secretary.

*Filed with hydra*

APR 26 1901

FILED

NOTE.—In case of a private road, the release must be executed in favor of the petitioner for said road.

Also—Viewers will carefully note the number of days employed, and set the amount out at the foot of their return.

Reviewers cannot interfere with damages assessed by the original viewers, except so far as the location may be changed by the reviewers.

N. B.—If the viewers believe the parties are not entitled to damages, taking into consideration the advantages as well as the disadvantages of the road, they will report to that effect.

AMOUNT.  
*Harry Byars* } Days 3  
Miles 13 \$ 13.30

*Edw Hoover* } Days 1  
Miles 13 \$ 3.30

*Alex Carter (2194)* } Days 1  
Miles 16 \$ 3.60

*Ellen Bowman* } Days 1  
Miles 0 1.50

*Harry England* } Days 1  
Miles 0 1.50  
*Edw Johnson* } Days 1  
Miles 0 1.50