

No.

3 Feby

Sessions, 190

31
1904

~~COMMONWEALTH~~

VERSUS

Review Public Road

in
Morris Township

17061

Road Docket #4 - Page #46

Charge

Bell

WILLIAM I. SWOOPF,
DISTRICT ATTORNEY.

Morrisdale-Morris Pa
Dec. 5 1904

This is to certify that
the new road leading from the -
N.Y.C. & P. Depot at Morrisdale
and connecting with the Road leading
from Oak Grove to Hunt & Run
is now open for Travel by all per-
sons wishing to use the same can
now do so in perfect safety -
by order of -

J. E. Emigh

} Supervisors
Morris Township
Glenfield Co. Pa

3 July 1904

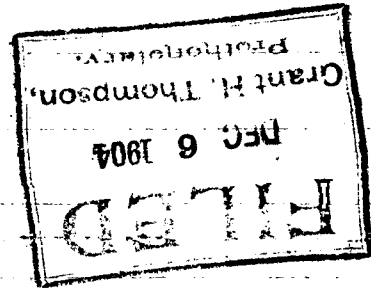

In the Court of Quarter Sessions of the
County of Clearfield.

The petition of the undersigned citizens of Adams Township respectfully represents.

That a road has lately been laid out to No 8 May Session 1903, which has been confirmed in si.

That your petitioners apprehend that the route as laid out is inconvenient, burdensome and that a better location can be had.

They therefore pray that proper persons be appointed to review the same and they will ever pray &c.

David Bailey

H. G. Vinely

John Hill

Franklin

J. J. Murphy

John

Chas. Hays

John B. Hays

John B. Hays

William B. Hays

John B. Hays

John B. Hays

John B. Hays

Gas a Wilson

H. C. Searcy

Wm. Lewis

C. H. Lewis

James H. Hays

John H. Hays

Wm. Davis

Joseph Hays

John Hays

M. C. George

S. T. Hallabough

Wm. Hays

Wm. Hays

Geo. Smith
Joseph S. Lemay
George Washburn
William Hepburn

1203 July 28 1904

Review of Road in
Mormi Brook Road
to 8 May 1903

Now 7th Dec AD 1903
on opening of Council
William Frederick
and Henry 13405
15 Morris & 22 1000
an opportunity
to ask according to
Confirmation of original and
Said finding this finding
by the Court
by the Court

SINGLETON BELL,
Attorney at Law,
DEC 7 1800 Clearfield, Penna.

KURTZ BROS. 1903, CLEARFIELD, PA.
e: 1100 1100

No. Sessions

Mary Byers,	{	Re-viewers
A. F. Norris,		
Ed. Woolridge		

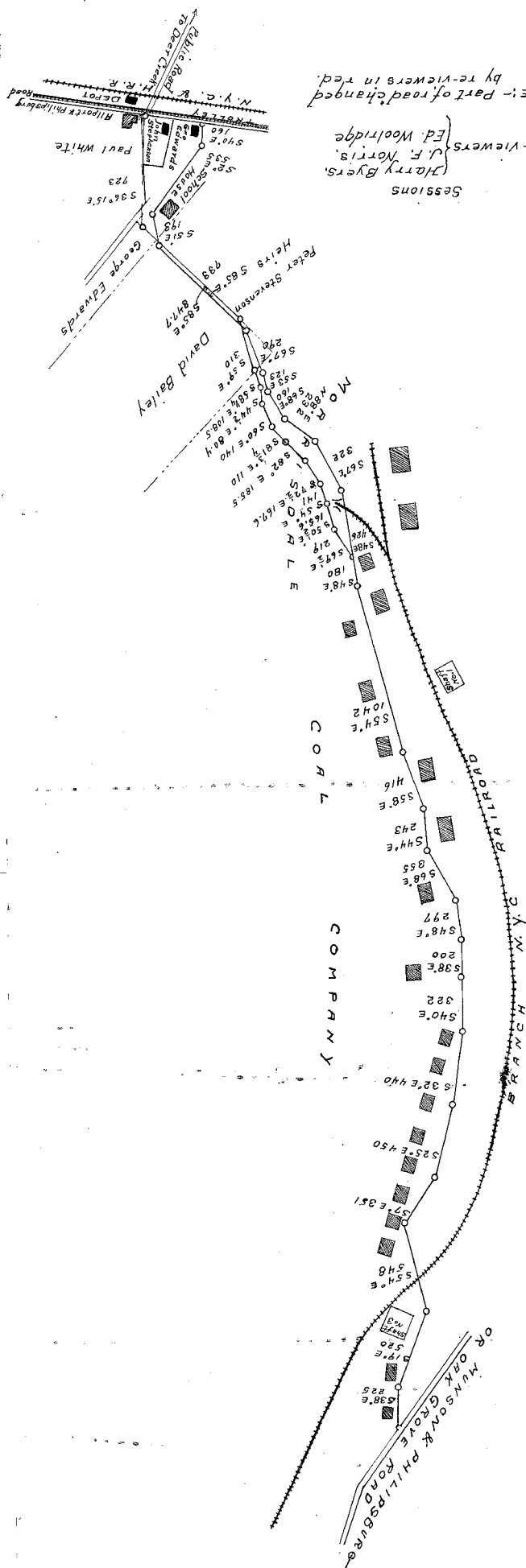

To the Honorable A. O. Smith President Judge of the Court of Quarter Sessions of Clearfield County, Pennsylvania.

We, the undersigned viewers appointed by the within order of court to re-view the road therein mentioned, respectfully report: That we gave lawful notice of said re-view by posting at least three notices of said view in public places in vicinity more than five days before the view, with notice to the County Commissioners and the Supervisors of Morris township which notices are attached hereto; that we met agreeable to said notices, the undersigned being present, and have viewed and laid out and do return for public use the following road, to wit Beginning at the Philipsburg and Allport road between the Beech Creek station and the house of Peter Stevenson, namely, sixteen and one-half feet eastwardly from the corner of Thomas White and John Stevenson, thence through improved land of said John Stevenson, Thomas White, Geo. Edwards and School lot, South 36 degrees and 15 minutes East (by line passing 16 1/2 feet westwardly from said Thomas White's south-east corner along school line) 723 feet to a post on line between school lot and George Edwards' land; thence by said line between said two pieces and on line between land of Peter Stevenson Heirs and David Bailey South 85 degrees East 847.7 feet to post on said line; thence crossing corner of said David Bailey's land South 59 degrees East 310 feet to a post; thence through land of Morrisdale Coal Company South 58 1/4 degrees East 108.5 feet to post; thence continuing through the same South 44 1/2 degrees East 80.4 feet to post; thence through the same South 60 degrees East 140 feet to a post; thence South 81 3/4 degrees East 110 feet to post; thence South 82 degrees East 185.5 feet to a White Oak sapling; thence South 72 1/2 degrees East 167.6 feet to White Oak sapling; thence South 54 degrees East through woods and fields of said coal company 141 feet to a post; thence through fields of same South 50 1/2 degrees East 165.6 feet to a post; thence through the same South 69 1/2 degrees East 219 feet to point on road laid out by former viewers; thence following road as laid out by viewers to No. 8, May SS., 1903 South 48 degrees East 180 feet; thence South 54 degrees East 1042 feet; thence South 58 degrees East 416 feet; thence South 44 degrees East 243 feet; thence South 68 degrees East 355 feet; thence South 48 degrees East 297 feet; thence South 38 degrees East 200 feet; thence South 40 degrees East 322 feet; thence South 32 degrees East 440 feet; thence South 25 degrees East 450 feet; thence South 7 degrees East 351 feet; thence South 54 degrees East 548 feet; thence South 19 degrees East 520 feet; thence South 38 degrees East 225 feet to the Munson and Philipsburg road near the Pardee school-house, which road as aforesaid laid out is necessary in our opinion for a public road. The road laid out to former view and changed by this present view is as follows: Beginning near the house of George Edwards, thence South 40 degrees East 160 feet; thence South 2 degrees East 535 feet; thence South 51 degrees East 193 feet; thence South 85 degrees East 733 feet; thence South 67 degrees East 290 feet; thence South 53 degrees East 123 feet; thence South 68 degrees East 160 feet; thence North 88 degrees East 232 feet; thence South 67 degrees East 322 feet; thence South 48 degrees East 426 feet to point where roads as located by two views coincide. A plot or draft of the roads as viewed and re-viewed showing courses, distances, and improvements is hereto attached, and damages are assessed elsewhere in this report. Witness our hands this 8th day of April A.D. 1904.

Harry Byers
J. B. Morris
Ed. Worbridge

Road Viewers' Notice!

NOTICE IS HEREBY GIVEN that the undersigned Viewers, appointed by the Court of Quarter Sessions of Clearfield County, Pennsylvania, to

RE-view *public* Road leading from the *Philipsburg and Allport* road at a point somewhere between the *Buch Creek Station* and the house of *Peter Stephenson*

in *Morris* Township, to connect with the *Munson and Philipsburg* road at or near the *Pardee school house*- said road having first been laid out to *Me 8 May 33, 1903*

in *Morris* Township, in the county aforesaid, will meet at the ~~house of~~ *Morrisdale Depot (N.Y.C. & H.R.R.)*, in *Morris* Township, on *Friday*, the *8th* day of *April*, A. D. 1904, at 9 o'clock A. M., to attend to the duty assigned them, of which time and place aforesaid all parties interested will please take notice.

Harry Byers
J. S. Morris
Ed Woodridge
Viewers.

Clearfield Pa. Mch 31, 1904.

Served on me 17th
first day of April
AD. 1904
No Commission
By W. H. Brown
per

no 3 Feb 85 1904
same

Road Viewers' Notice!

NOTICE IS HEREBY GIVEN that the under-
signed Viewers, appointed by the Court of Quarter
Sessions of Clearfield County, Pennsylvania, to

Re-view public Road leading from
The Philipsburg and all part road at a
point somewhere between the Beech
Creek Station and the house of Peter
Stephenson

in Morris Township, to connect
with the Monson & Philipsburg road
at or near the Pardee School
house - Said road having been let
out to the 8 May 53 1903

in Morris Township, in the county
aforesaid, will meet at the ~~house of~~ Morrisdale
Depot (NYC & HRR), in Morris
Township, on Friday, the 8th
day of April, A. D. 1904, at 9 o'clock
M., to attend to the duty assigned them, of which
time and place aforesaid all parties interested will
please take notice

Harry Byers
J. S. Morris
Ed Wookidge
Viewers.

Clearfield Pa. Mch 31, 1904.

Served on us this first day
of April A.D. 1904

Supervisors of
Morris Township } Jas B. Corriple
 } Theo. Deane

Review Morris

Clearfield County, ss:

At a Court of Quarter Sessions of the Peace of the county of Clearfield, Pennsylvania, held at Clearfield, in and for said county, on the 3 day of July, A. D. 1904, before the Judge of said Court, upon a petition of sundry inhabitants of the township of Morris, in said county, setting forth that

The petition of the undersigned citizens of Morris Twp. respectfully represents that a Road has lately been laid out to No. 8 May Term 1903 which has been confirmed Ni si.

That your petitioners apprehend that the route as laid out is inconvenient and burdensome and that a better location can be had. They therefore pray that proper persons be appointed to Review the same

and therefore praying the Court to appoint proper persons to view and lay out the same according to law, Report to May Term 1904 whereupon the Court, upon due consideration had of the premises, do order and appoint Harry Byers J. S. Norris and Ed Woolridge who, after being respectively sworn or affirmed to perform the duties of their appointment with impartiality and fidelity, are to view the grounds proposed for said road, and if they view the same and any two of the actual viewers agree that there is occasion for such road, they shall proceed to Review and lay out the same agreeable to the desire of the petitioners, as may be, having respect to the best ground for a road and the shortest distance, and in such manner as to do the least injury to private property, and state particularly, whether they judge the same necessary for a PUBLIC or PRIVATE road, together with a plot or draft of the same, with the courses and distances and reference to the improvements through which it passes, and shall also procure releases of damages from persons through whose land said road may pass, or failing to procure such releases, shall assess the same, if any sustained, and shall make report thereof to the next Court of Quarter Sessions to be held for said county, in which report they shall state that they have been sworn and affirmed according to law. Notice is directed to be given to the owners or occupants of seated land through which the within road is intended to pass, of the time of the view, according to the 147th Rule of Court.

BY THE COURT.

Grant H. Thompson
Clerk.

RETURN OF DAMAGES.

Know all Men by these Presents, That we, the undersigned owners of lands through which the road located by the viewers, under the annexed order, passes for and in consideration of the sum of ONE DOLLAR to us respectively paid by the..... at and before the enrolling and delivery hereof, have remised, released and forever quit-claimed; and do hereby remise, release and forever quit-claim to the said..... all damages that may arise to us respectively by reason of the location and opening of the said road, so that neither we nor any of us, nor any person claiming under us, can or may hereafter ask, sue for, demand, have or receive any damages for injuries arising or growing out of the location and opening of the road aforesaid.

Witness our hands and seals this..... day of.....
A. D. 190.....

..... Seal

..... Seal

..... Seal

..... Seal

ASSESSMENT OF DAMAGES.

The following persons, having refused to release the damages to which they respectively may be entitled by reason of the location and the opening of the said road in the annexed return described, we, the undersigned viewers, under oath in pursuance of our duty, under the Act of Assembly, do assess their damages and make report thereof, as follows:

To John Stephenson the sum of seventy-five dollars
To Thomas White the sum of twenty-five "
To George Edwards the sum of fifteen dollars
To Peter Stephenson the sum of twenty-five dollars
To David Bailey the sum of twenty-five dollars
to School Lot and Morrisdale Coal Company nothing
Witness our hands this 8th day of April A. D. 1906

Harry Byers,

J. B. Morris,

E. J. McElroy

No. 3 July Sessions, 1904

ORDER

To view and lay out a road for public use in the township of Morris, Clearfield County

May Sessions, 1904
read and confirmed Ni. Si.
Road to be opened 33 feet wide, except where there is side hill cutting or embankment and bridging, there to be 16 feet wide.

By the Court
sent W. 1904 confirmed absolutely. By the Court
Whose D. Smith

Grant H. Thompson,
Notary.
MAY 25 1904
Paid by D. Ryer
F. 11 22
F. 11 22

NOTE.—In case of a private road, the release must be executed in favor of the petitioner for said road.
Also.—Viewers will carefully note the number of days employed, and set the amount out at the foot of their return.
Also.—Viewers cannot interfere with damages assessed by the original viewers, except so far as the location may be changed by the reviewers.
N. B.—If the viewers believe the parties are not entitled to damages, taking into consideration the advantages as well as the disadvantages of the road, they will report to that effect.

Harry Byrd	Days 2	Miles 17	9.76
J. S. Morris	Days 1	Miles 11	3.10
Ed. Worbridge	Days 1	Miles 16	3.60
Thomas M. T. Morris	Days 1	Miles 15	1.50
Chairman	Days 1	Miles 15	1.50
Jos. S. Davis	Days 1	Miles 15	1.50
Chairman	Days 1	Miles 15	1.50
James F. Fowler	Days 1	Miles 15	1.50
Chairman	Days 1	Miles 15	1.50