

ROAD

DOCKET No. 6

Number

Term

Year

3

Dec. SS

1940

Re; Petition for Roads in
Beccaria Township

Versus

IN THE COURT OF QUARTER SESSIONS OF CLEARFIELD COUNTY, PENNA.

In re: PETITION FOR ROADS :
 :
 IN BECCARIA TOWNSHIP :

ORDER.

NOW September 23, 1940, in accordance with the attached
Petition, John Scollins, Esq., T. C. McGarvey and H. A. Reese
are appointed viewers with the usual powers to pass upon the
matters contained in the Petition.

By the Court,

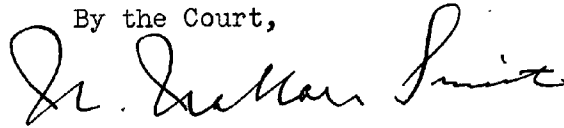
A handwritten signature in cursive script, likely of the President Judge, written in dark ink.

President Judge.

PETITION.

Attest: Edna Wallace W. Smith, President Judge of Clearfield County, Pa.

GREETINGS: We, the undersigned petitioners, desire that you appoint viewers to appraise the following streets in Blain City, Beccaria Township, Clearfield County, Pennsylvania, and for the purpose of having these streets assigned to the Board of Road Supervisors of Beccaria Township as part of the rural Township Roads to share in the allocation of State funds, and the regular assessed tax funds for their respective care and maintenance viz:

LINWOOD STREET, Beginning at Clearfield Creek and extending eastward approximately 800 feet to Railroad Street.

RAILROAD STREET, Beginning at the intersection of Locust Street and
extending northward approximately 800 feet to Walnut street.

PINE STREET, Beginning at the intersection of Locust street and extending northward approximately 1000 feet to First Avenue.

LIBERTY STREET, Beginning at the intersection of Locust street and extending northward approximately 1000 feet to First Avenue.

WALNUT STREET, Beginning at the intersection of Railroad Street and extending eastward approximately 1000 feet to Liberty Avenue.

RESPECTFULLY.

Ther. H. Flickinger

Ernest L. Shore

W. J. Jasher

John Wiser

W. E. Thomas

Wm. L. Thompson

Bernard Barker

J. C. Harlie

Clair Harber

George Berger

Henry B. Robinson

Fred Brinkman

Paul G. Lesher

Monday 2 Nov/20

22 11/11

Alfred J. Williams

John Lincoln

Chas. W. C. C. C.
Julia, 1912

Blain City - Coalgate, O. O. 7-2640

Blain City Coalport Po 7-30-70

Blain City - Coalport P.O. 7/30/44

Blaine City Court No. 23 ¹⁷⁰ ₀₄₂

Plain City Coal Co. P. 7-30-4,

William Pitt Rivers, P. 730-43

Blain City Coalport po. 73.

Blair City Co. 1-00

B. Cain City Chicago Ill. 7.30.9.

Blaine City Comfort 10-7-30-40

Blair CT by Coalport Pa 1204

Blain City Coalport Co. 750-

Bloom City Coalport P.O. 7-38

Plain and leafy

B. Lavin City Coalport
D.D. C.A.R. 11 B.

Black City Coal Co. 5-10-40
Blair & Co. 5-10-40

~~Ways and Means~~

Wesley K. Orre

1407

In re Appointment

of _____

for _____

Clearfield County, Pa.

Now

Petition read and considered.

Thereupon

is appointed

for the

of

to fill the vacancy caused by

Approved by the Court,

P.

PETITION.

To the _____ of Clearfield, County, Pa.

GREETINGS:—We, the undersigned petitioners, desire the appointment of _____

to fill the office of _____

for the _____ of _____ Borough Township

as a vacancy in said office now exists, caused by _____

Respectfully,

John S. Bolinger

Ira D. Smyers

John Leonard Reeger

Carl E. Nelson

David Keith

John Barts

Frank Barts

Norman S. Spongle

Charles Disten

Geo. W. Dietrich

Clarence Aske

Miss Ruffner

Mary Enshuman

James Enshuman

Charles Enshuman

Emma Ruffner

Coalport, Pa

Blain City Coalport P.O.

Blain City Coalport Pa. P.O. 7-30

Blain City Coalport Pa. P.O.

Blain City Coalport Pa.

Blain City Coalport Pa.

Blain City Coalport Pa.

Blain City Coalport, Pa.

Blain City Coalport, Pa. 7-30

Blain City Coalport, Pa.

Blain City Coalport, Pa.

Blain City Coalport Pa.

Blain City Coalport Pa.

Blain City Coalport Pa.

Blain City Coalport Pa.

Blain City

In re Appointment

of

for

Clearfield County, Pa.

Now

Petition read and considered.

Thereupon

is appointed

for the

of

to fill the vacancy caused by

Approved by the Court,

P.

(Handwritten signature)

George C Myers
Kathryn Myers
Anne Galloway
Thomas Galloway
Jilliah Lightner
Mrs Wm Keyser
Wm Keyser
7/31/46 James Keith
Melvin Keith
Ed Berger
J.B. Heleman Sydeman
Wm Merhing
Francis J. Kelly
Fr. J. Cannon
Hale O'Connell
Carl B Weakland
Dan McCoy

Blain City Coalport P.O. 7/31/46
Blain City, Coalport, P.O. 7/31/46
Blain city, Coalport P.O. 7/31/46
Blain city - Coalport P.O. 7/31/46
Blain City Coalport P.O. 7/31/46
Blain City Coalport B312
Blain City Coalport B31
Blain City Coalport Pa
Blain City Coalport
Blain City Coalport
Coalport Pa
Blain City Coalport Pa. 8/1/46
Blain City Pa. 8/1/46
Blain City, Pa.
Supervisor
Supervisor
" " " "

No. 3 Dec. 22 1940

IN THE COURT OF QUARTER
SESSIONS OF CLEARFIELD
COUNTY, PENNA.

In re: Petition for Roads
In Beccaria Township

ORDER.

[Handwritten signature]

In re: Order to view and lay out } In the Court of Quarter Sessions
certain streets in Blain City as } of Clearfield County, Penn'a.
part of the rural Township Roads }
of Beccaria Township. } No. 3, December SS., 1940.

Petition to Amend Petition.

To the Honorable W. Wallace Smith, President Judge of said Court:

The petition of Ernest Shore in behalf of himself and the petitioners in the original, petition for the laying out of certain streets and alleys in Blain City as public highways of Beccaria Township, to the above number and term of Court, respectfully represents:

1. That on the 23rd day of September, 1940, your petitioner and others presented to your Honorable Court, a "Petition for Roads in Beccaria Township", setting forth that the petitioners named therein labored under inconvenience for want of certain public roads in the Township of Beccaria, to wit:

LINWOOD STREET, Beginning at Clearfield Creek and extending eastward approximately 800 feet to Railroad Street.

RAILROAD STREET, Beginning at the intersection of Locust Street and extending northward approximately 800 feet to Walnut Street.

PINE STREET, Beginning at the intersection of Locust Street and extending northward approximately 1000 feet to First Avenue.

~~Chestnut~~ LIBERTY STREET, Beginning at the intersection of ~~Chestnut~~ Street and extending northward approximately 1000 feet to First Avenue.

WALNUT STREET, Beginning at the intersection of Railroad Street and extending eastward approximately 1000 feet to Liberty Avenue:

And praying for the appointment of viewers to lay out the same according to law.

2. That on the same day, to wit: September 23, 1940, John Scollins, Esq., T. C. McGarvey and H. A. Reese were appointed viewers in accordance with the prayer of the petition.

3. That it now appears that your petitioner inadvertently neglected to include in the original petition "An Alley leading from Locust Street (Route 531) to the Consolidated public school house and thence to the Improved public road (Route 532)".

WHEREFORE, your petitioner prays that the description

set forth in the original petition may be amended to include
"An Alley leading from Locust Street (Route 531) to the Consoli-
dated public school house and tence to the Improved public road
(Route 532)."

And he will ever pray.

Ernest C Shore

CLEARFIELD COUNTY, SS:

ERNEST SHORE, petitioner above named, being
duly sworn according to law deposes and says that the facts
set forth herein are true and correct.

Ernest C Shore

Sworn and subscribed before me,
this 28th day of October, 1940.

J. W. Laing Jr

My Commission Expires
first Monday in January 1942

ORDER

AND NOW, this ~~27th~~ day of *Oct*, 1940, the within petition presented, read and considered: whereupon it is ordered that the description set forth in the original Order filed in this proceeding is hereby amended to read as follows:

"LINWOOD STREET, Beginning at Clearfield Creek and extending eastward approximately 800 feet to Railroad Street".

"Railroad Street, Beginning at the intersection of Locust Street and extending northward approximately 800 feet to Walnut Street".

"PINE STREET, Beginning at the intersection of Locust Street and extending northward approximately 1000 feet to First Avenue".

Chestnut ~~Locust~~ "LIBERTY STREET, Beginning at the intersection of ~~Locust~~ Street and extending northward approximately 1000 feet to First Avenue".

"WALNUT STREET, Beginning at the intersection of Railroad Street and extending eastward approximately 1000 feet to Liberty Avenue". And an

"ALLEY leading from Locust Street (Route 531) to the Consolidated public school house and thence to the Improved public road (Route 532)".

BY THE COURT,

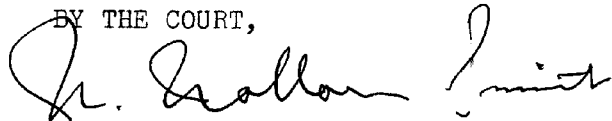

P. J.

IN THE COURT OF QUARTER
SESSIONS OF CLEARFIELD COUNTY
PENNSYLVANIA.

No. 3, December SS., 1940.

In re: Order to view and lay
out certain streets in Blain
City as part of the rural
Township Roads of Beccaria
Township.

Petition to Amend Petition.

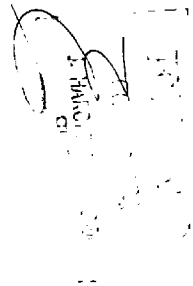
JOHN SCOLLINS
ATTORNEY AT LAW
HOUTZDALE, PA.

IN THE COURT OF QUARTER SESSIONS OF CLEARFIELD COUNTY, PENNA.

In re: Order to view and lay out :
certain streets in Blain City as : No. 3 December Sessions, 1940
part of the rural Township Roads :
of Beccaria Township :

October 29, 1940, Petition of Ernest C. Shore to Amend Petition
filed.

ORDER

AND NOW, October 29, 1940, the within petition presented,
read and considered; whereupon it is ordered that the description
set forth in the original Order filed in this proceeding is hereby
amended to read as follows:

"LINWOOD STREET, Beginning at Clearfield Creek and
extending eastward approximately 800 feet to Railroad Street".

"RAILROAD STREET, Beginning at the intersection of
Locust Street and extending northward approximately 800 feet to
Walnut Street".

"PINE STREET, Beginning at the intersection of Locust
Street and extending northward approximately 1000 feet to
First Avenue".

"LIBERTY STREET, Beginning at the intersection of
Chestnut Street and extending northward approximately 1000 feet
to First Avenue".

"WALNUT STREET, Beginning at the intersection of
Railroad Street and extending eastward approximately 1000 feet
to Liberty Avenue". And an

"ALLEY leading from Locust Street (Route 531) to the
Consolidated public school house and thence to the Improved
public road (Route 532)".

By the Court,

W. Wallace Smith

President Judge

Certified from the record this 29th day of October, A. D. 1940.

J. Harold McTadden
Clerk

At a special meeting of the Board of Supervisors of the Township of Beccaria, held at Coalport, Pa., on the 16th day of October, 1940, the following members being present: Dan McCoy, Dale O'Donnell and Carl Weakland, the following resolution was adopted:

Whereas, on October 12, 1904, a plan of Blain City, North of the Pennsylvania Railroad, in said Township, was filed in the Office of the Recorder of Deeds in Clearfield County in Misc. Book "V", page 95, and in 1938, a later plan recorded in Misc. Book 52, page 47; with streets and alleys dedicated to public use; those streets running north and south being 50 feet in width, and those running east and west being 40 feet in width; and the width of the alleys not stated, but measuring 20 feet between fence lines; and

Whereas, a petition has been presented to the Court of Quarter Sessions of Clearfield, to No. 3, December Term, 1940, praying that

"Linwood Street, Beginning at Clearfield Creek and extending eastward approximately 800 feet to Railroad Street."

"Railroad Street, Beginning at the intersection of Locust Street and extending northward approximately 800 feet to Walnut Street".

"Pine Street, Beginning at the intersection of Locust Street and extending northward approximately 1000 feet to First Avenue".

"Liberty Street, Beginning at the intersection of Locust Street and extending northward approximately 1000 feet to First Avenue".

"Walnut Street, Beginning at the intersection of Railroad Street and extending eastward approximately 1000 feet to Liberty Avenue".

And an "Alley leading from Locust Street (Route 531) to the Consolidated public school house and thence to the Improved public road (Route 532)"

be laid out as public highways and that Beccaria Township adopt and maintain them as such; and

Whereas, a Board of Viewers has been appointed to view and lay out the said streets and alleys as mapped and plotted on the attached plan, made by H. A. Reese of said Board:

Now, therefore, be it resolved that the Board of Supervisors of Beccaria Township adopt and approve the aforesaid certain streets and alleys as public highways of the said Township; that a blue-print thereof be recorded in the minutes of the Board; and that a copy of this resolution be certified and filed with the Board of Viewers, and recommend acceptance and approval thereof by the Court. On motion duly made and seconded, Resolution adopted, all members voting affirmatively.

I hereby certify that the foregoing is a true and correct copy of the minutes of a special meeting held October 16, 1940, of the Board of Supervisors of Beccaria Township.

Witness my hand and official seal.

H. F. Estreich, Secy.
Carl Weakland, Pres.

TO: Dan McCoy, Dale O'Donnell and Carl E. Weakland,
Supervisors of Beccaria Township:

IN THE COURT OF QUARTER SESSIONS OF CLEARFIELD COUNTY,
PENNSYLVANIA.

In re: Order to view and lay out
certain streets in Blain City as
part of the rural Township Roads
of Beccaria Township.

NO. 3, December SS., 1940.

You are hereby notified that the undersigned Viewers, appointed by the Court to the above number and term, to view and lay out certain streets in Blain City as part of the rural Township Roads of Beccaria Township, to wit:

"LINWOOD STREET, Beginning at Clearfield Creek and extending eastward approximately 800 feet to Railroad Street".

"RAILROAD STREET, Beginning at the intersection of Locust Street and extending northward approximately 800 feet to Walnut Street".

"PINE STREET, Beginning at the intersection of Locust Street and extending northward approximately 1000 feet to First Avenue".

"LIBERTY STREET, Beginning at the intersection of Locust Street and extending northward approximately 1000 feet to First Avenue".

"WALNUT STREET, Beginning at the intersection of Railroad Street and extending eastward approximately 1000 feet to Liberty Avenue".

in the County aforesaid, will meet at Linwood Street and Clearfield Creek in Blain City on Wednesday, October 16th, 1940 at ten (10) o'clock A. M., to attend to the duty assigned them; of which time and place aforesaid all parties interested will take notice.

And that the public hearing required by Act of Assembly and the Rules of Court to be held by the Viewers before the filing of their report in Court, in order to give all parties interested in the said roads an opportunity to be heard, will be held in the Grand Jury Room in the Court House in Clearfield, on Saturday, October 19th, 1940 at 10:00 o'clock A. M., or as soon thereafter as counsel can be heard, at which time and place all parties interested may attend and be heard.

John Collins
T. C. Mc Garvey
N. A. Reese
Viewers

Dated: October 2nd, 1940.

CLEARFIELD COUNTY, SS:

NOW, this 12 day of October, 1940, service of the above Notice is accepted for the Supervisors of Beccaria Township.

Carl E. Weakland
Dan McCoy
Dale O'Donnell
Supervisors.

TO: The County Commissioners of Clearfield County, Penn'a.:

IN THE COURT OF QUARTER SESSIONS OF CLEARFIELD COUNTY,
PENNSYLVANIA.

In re: Order to view and lay out
certain streets in Blain City as
part of the rural Township Roads
of Beccaria Township.

NO. 3, December SS., 1940.

You are hereby notified that the undersigned Viewers, appointed by the Court to the above number and term, to view and lay out certain streets in Blain City as part of the rural Township Roads of Beccaria Township, to wit:

"LINWOOD STREET, Beginning at Clearfield Creek and extending eastward approximately 800 feet to Railroad Street".

"RAILROAD STREET, Beginning at the intersection of Locust Street and extending northward approximately 800 feet to Walnut Street".

"PINE STREET, Beginning at the intersection of Locust Street and extending northward approximately 1000 feet to First Avenue".

"LIBERTY STREET, Beginning at the intersection of Locust Street and extending northward approximately 1000 feet to First Avenue".

"WALNUT STREET, Beginning at the intersection of Railroad Street and extending eastward approximately 1000 feet to Liberty Avenue".

in the County aforesaid, will meet at Linwood Street and Clearfield Creek in Blain City on Wednesday, October 16th, 1940 at ten (10) o'clock A. M., to attend to the duty assigned them; of which time and place aforesaid all parties interested will take notice.

And that the public hearing required by Act of Assembly and the Rules of Court to be held by the Viewers before the filing of their report in Court, in order to give all parties interested in the said roads an opportunity to be heard, will be held in the Grand Jury Room in the Court House in Clearfield, on Saturday, October 13th, 1940 at 10:00 o'clock A. M., or as soon thereafter as counsel can be heard, at which time and place all parties interested may attend and be heard.

John Collins
T. C. McHarvey
H. A. Reesi
Viewers

Dated: October 2nd, 1940.

CLEARFIELD COUNTY, SS:

NOW, this 3rd day of October, 1940, service of the above Notice is accepted for the Commissioners of Clearfield County.

James B. Rees
Clerk

Coalport, Pa., Oct. 17, 1940

To Whom it may concern:

WE, the undersigned owners of property on either side of the proposed improved fourteen foot road from Powis' corner to the Blain City School Building, hereby agree to donate enough land on either side of the present road to allow for a thirty-three foot Right of Way.

Signed... Jesse J. Bolinger
... William E. Bolinger per W. E. Bolinger
... Rosella Krosch

[illegible]

Coalport, Pa.
October 18, 1940

To Board Supervisors of
Beccomish Township:

Thereby give the
necessary footage as
my share of the 33
ft necessary, by law,
for the construction of
a road surfaced
road from the in-
tersection at Foxess^{cross} across
to the Plain City School.

(Signed) Wm Mand Dick

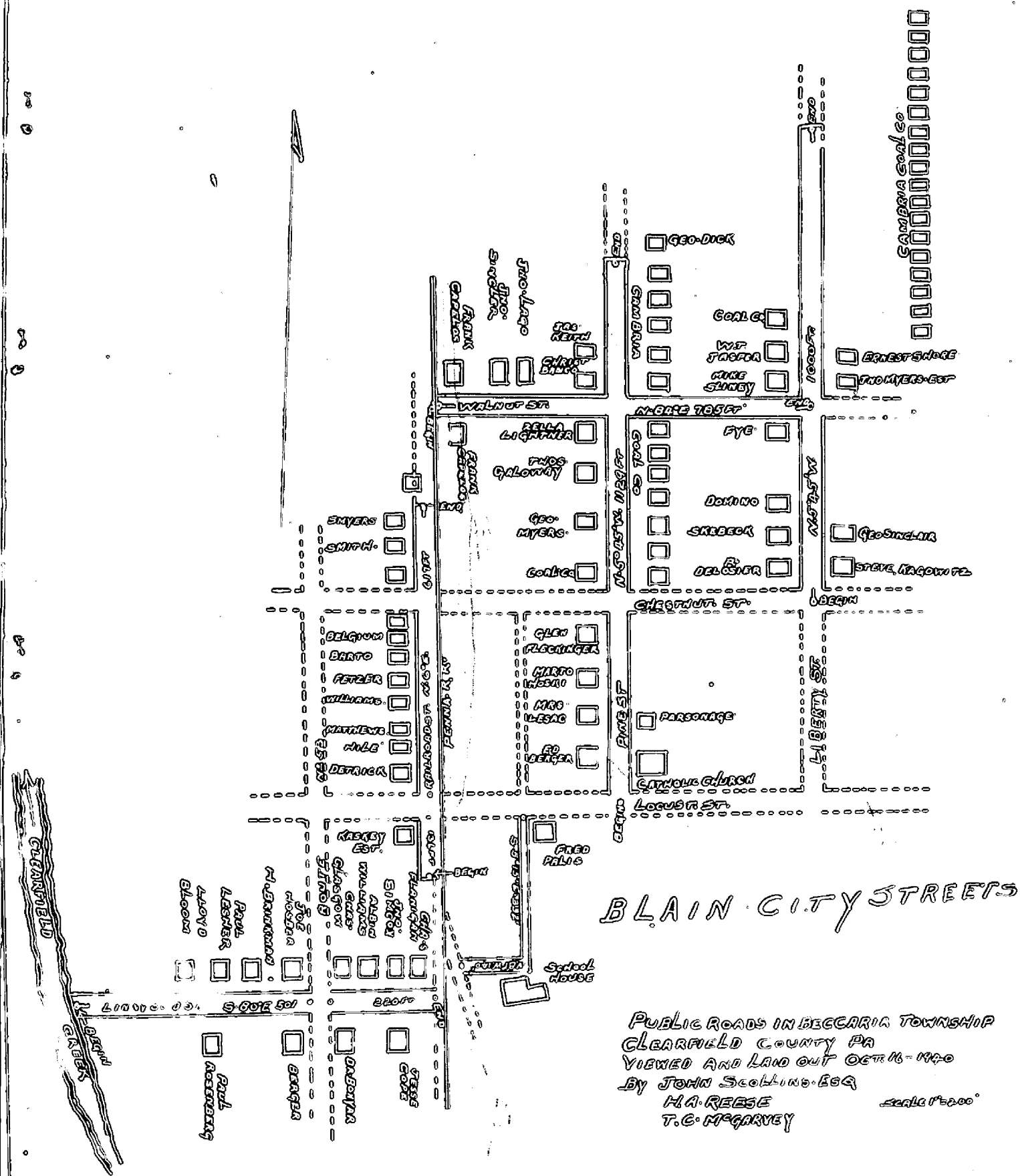

BLAIN CITY STREETS

PUBLIC ROADS IN BECCARIA TOWNSHIP
 CLEARFIELD COUNTY PA
 VIEWED AND Laid OUT OCT 16 - 1940
 BY JOHN SCOLLINS ESQ
 H.A. REESE
 T.C. MCGARVEY

SCALE 1" = 200'

Clearfield County, ss:

At a Court of Quarter Sessions of the Peace of the County of Clearfield, held at Clearfield, Pa., in and for said County, on the 24th day of September in the year of our Lord one thousand nine hundred and Forty.

Judge of the same Court: Upon the petition of sundry inhabitants of the Township of Beccaria

in said County, setting forth that viewers be appointed to appraise the following streets in Blain City, Beccaria Township for the purpose of having these streets assigned to the Board of Road Supervisors of Beccaria Township as part of the Rural Twp. Roads, viz:

LINWOOD STREET, Beginning at Clearfield Creek and extending eastward approximately 800 feet to Railroad St. RAILROAD STREET, Beginning at the intersection of Locust St. and extending northward approximately 800 feet to Walnut Street. PINE STREET, Beginning at the intersection of Locust St. and extending northward approximately 1000 feet to First Avenue. LIBERTY STREET, Beginning at the intersection of Locust St. and extending northward approximately 1000 ft. to First Avenue. WALNUT STREET, Beginning at the intersection of Railroad St. and extending eastward approximately 1000 feet to Liberty Avenue.

and therefore, praying the Court to appoint proper persons to view and lay out the road between the points mentioned, whereupon the Court upon due consideration had of the premises, do order and appoint from and among the County Board of Viewers John Scollins, Esq.,

T. C. McGarvey and H. A. Reese

who have been duly appointed by the Court and filed their oaths of office and are duly qualified to perform the duties of their appointment with impartiality and according to the best of their judgement, are to view the ground proposed for the said road, and if they view the same, and a majority of the actual viewers agree that there is occasion for such road they shall proceed to lay out the same, as agreeable to the desire of the petitioner as may be, having respect to the best ground for a road and the shortest distance, in such a manner as to do the least injury to private property; and shall make report thereof, stating particularly whether they judge the same necessary for a public or private road, together with a plot or draft thereof, and the courses and distances and references to the improvements through which the same may pass; (and wherever practicable, the viewers shall lay out the said road at an elevation not exceeding five degrees, except at the crossing of ravines and streams, when by moderate filling and bridging the declination of the road may be preserved within that limit,) to the next Court of Quarter Sessions to be held for the said County.

And if the viewers aforesaid shall decide in favor of locating a public road, they shall obtain from the persons through whose lands the said road shall pass, releases from any damages that may arise to them on opening the same; but if the owner or owners of such land refuse to release their claim to damages, the said viewers shall assess the same, taking into view the advantages as well as disadvantages arising from said location, and make report of such assessments; which report they shall in like manner transmit to the next Court of Quarter Sessions, with the draft or plot aforesaid. In which said reports they shall state that they have been sworn or affirmed according to law, and that due and legal notice was given of the time when, and place where, they should meet, to view and lay out said road, and the time and place of hearing

By order of the Court. W. Wallace Smith, Pa. J.

J. Harold McGadden, Clerk.

RETURN OF VIEWERS

To the Honorable the Judge of the Court of Quarter Sessions of the Peace for the County of Clearfield:

We, the undersigned viewers, duly appointed by your Honorable Court by the foregoing order from and among the County Board of Viewers who have been duly appointed by your Honorable Court and have filed their oaths of office in the Court of Common Pleas of Clearfield County, be leave to report as follows:

That notice of the time of view and of the hearing day was duly served according to law upon the Commissioners of Clearfield County and the Board of Supervisors of the Township of

Beccaria and that three notices thereof were posted along the route of the proposed road, that the said view would be held on the 15th day of October A. D. 1940, and the hearing to be held in the ^{Grand Jury} ~~session~~ Room, at the Court House, in Clearfield, Pa., on the 19th day of October, 1940, at 10 o'clock A. M. That three viewers appointed by the said order viewed the ground proposed for the above mentioned road, and that there were present at the view Ernest Shore, Raymond Caskey, Harold Caskey, Jesse Kope, petitioners; Dan McCoy, Carl Weakland and Dale O'Donnell, Supervisors,

parties in interest. That the hearing was held in the ^{Grand Jury} ~~session~~ Room, in the Court House, at Clearfield, Pa., on the 19th day of October A. D. 1940, when the following appearances were noted: Dan McCoy, Dale O'Donnell and Carl Weakland, Supervisors; Edgar Shenley, W. B. Heil, W. E. Bollinger, E. M. Hess, and Ernest Shore, petitioners; all of whom were duly sworn, examined and cross-examined by your Board.

After the view and hearing above mentioned, the undersigned, the majority of the said viewers, do agree that there is _____ occasion for a road as desired by the petitioner, and that the same is _____ necessary for a public road: And having had respect to the shortest distance and the best ground for such road we have laid out in such manner as shall do the least injury to private property, and as far as practicable agreeably to the desire of the petitioner, and do return for public use the following described road, to wit

✓ ~~Beginning~~ "LINWOOD STREET, Beginning at Clearfield Creek and running South 80 degrees East five hundred and one feet to Right-of-Way of State Highway Route No. 53; and thence from the northern line of said Right-of-Way South 80 degrees East two hundred and twenty feet and ending in the Right-of-Way of the Pennsylvania Railroad".

✓ "RAILROAD STREET, Beginning at a post in Railroad Street and thence running North 6 degrees East one hundred and thirty-six feet to Right-of-Way of State Highway Route No. 53 on Locust Street; and thence from the western line of said Right-of-Way North 6 degrees East six hundred and seventeen feet and ending in said Railroad Street".

✓ "PINE STREET, Beginning at its intersection with Locust Street (Improved) and thence running North 5 degrees 45 minutes West eleven hundred and twenty-nine feet, and ending in First Avenue".

✓ "LIBERTY STREET, Beginning at its intersection with Chestnut Street, and thence running North 5 degrees 45 minutes West one thousand feet and ending in First Avenue".

✓ "WALNUT STREET, Beginning at its intersection with the Right of-Way of State Highway Route No. 53 on Railroad Street, and thence running North 84 degrees East seven hundred and eighty-five feet, and ending in Liberty Street aforesaid".

✓ "ALLEY leading from Locust Street (Improved Route 531) at the property lines of Fred Pallis and thence running South 5 degrees 15 minutes East, three hundred and thirty-two feet to the Consolidated Public School lot; and thence thereby running North 81 degrees West one hundred and forty feet and ending in the Improved Public Highway (Route 532):

✓ ALL according to plan of the Village of Blain City, in the Township of Beccaria, and recorded in the Office of the Recorder of Deeds in and for Clearfield County, October 12, 1904, in Misc. Book Vol. "V", page 95; and the "Shaw & Dotte Plan" of Blain City recorded in Misc. Book Vol. 52, page 47.

Your Board further finds: that the Village of Blain City with plan os lots, and streets and alleys dedicated to public use has been laid out for a period longer than 40 years; the streets running north and south being 50 feet in width; those running east and west 40 feet in width; and the Alleys 20 feet between fence lines.

That the Board of Supervisors, at a special meeting held on October 15th, 1940, adopted and approved the aforesaid streets and alleys as public highways of said Township, recorded a blue-print thereof in their minutes, and recommended acceptance and approval thereof by the Court, (a certified copy of their resolution being hereto attached and made a part hereof).

That the present "turn-out" at the Consolidated Public School is too narrow and dangerous for loading and unloading children and the turning of school-busses, which are now required to back into the Improved highway to turn.

That the said Village of Blain City is well built-up, populated and in need of the public roads as particularly described herein, the same being necessary for public travel and accomodation,

Wherefore, your Board recommends the adoption of said streets and alley as public highways of the Township of Beccaria, as laid out and particularly described herein,

and that a plan or draft of said road showing courses and distances and the properties affected is hereto attached and made a part hereof, said road being at an elevation not exceeding five degrees, excepting _____

when it was not practical to preserve it within that limit.

The undersigned further report that they endeavored to procure from all the owners of the land over which the said road passes releases in writing of all claims to damages that may arise from opening the same, and that they procured such releases from Mrs. Maud Dick, Jesse J. Bollinger, William E. Bollinger and Rosella Krozel: which are hereto attached and made a part hereof;

the following persons having refused to release the damages to which they respectfully may be entitled by reason of the location and opening of the said road, we, the undersigned viewers, after having considered the advantages to be derived to them, do assess them damages and make report thereof as follows: The streets and alleys having been dedicated as public thorofares and accepted by the public and residents as such, no damages are assessable,

and we herewith return releases obtained and copy of the notices.

WITNESS our hands and seals this 15th day of November

A. D. 1940..

John Seelind Seal
H. A. Reese Seal
T. C. McSawey Seal
Seal

ORDER

To view Roads _____
 road for _____ use in the
 township of Beccaria _____
 Clearfield County _____

Deer Sessions, 1940,
 read and confirmed Ni. Si. Road to be
 opened 33 feet wide, except where there
 is side hill cutting or embankment and
 bridging, there to be 16 feet wide

R. Walker

*Mr. 3, 1941. Confirmed
 duty. By 1st
 R. Walker*

Filed _____ 19____
 Fees \$1.25 paid by _____

NOTE.—In case of a private road, the release must be executed in favor of the petitioner for said road.

Also, viewers will carefully note the number of days employed and set the amount out at the foot of their return.

Reviewers cannot interfere with the damages assessed by the original viewers, except so far as the location may be changed by the reviewers.

N. B.—If the viewers believe the parties are not entitled to damages, taking into consideration the advantages as well as the disadvantages of the road, they will report to that effect.

	DAYS	MILES	AM'T.
H. A. Reese	4	128	46.40
T. C. McGarvey	2	80	24.00
John Scollins	4	88	44.40

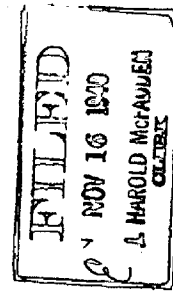

RELEASE OF DAMAGES

Know all Men by these Presents, that we, the undersigned, owners of lands through which the road located by the viewers, under the annexed order, passes for and in consideration of the sum of one dollar to us respectively paid by _____

_____ at and before the ensembling and delivery hereof, have remised, released and forever quit-claimed, and do hereby remise, release and forever quit-claim to the said _____

all damages that may arise to us respectfully by reason of the location and opening of the said road, so that neither we nor any of us, nor any person claiming under us, can or may hereafter ask, sue for, demand, have or receive any damages for injuries arising or growing out of the location and opening of the road aforesaid.

Witness our hands and seals this _____ day of _____
 A. D. 192_____.

Seal
 Seal
 Seal
 Seal