

ROAD

**DOCKET NO.** 7

| Number | Term | Year |
|--------|------|------|
|--------|------|------|

|          |                     |             |
|----------|---------------------|-------------|
| <u>3</u> | <u>May Sessions</u> | <u>1957</u> |
|----------|---------------------|-------------|

Re: Adoption of a Portion of Shaw  
Street as a Part of the Road  
System of Lawrence Township

**Versus**

\_\_\_\_\_

\_\_\_\_\_

\_\_\_\_\_

# VILLAGE OF PLYMPTONVILLE



*Legal Right-of-Way Line 7*

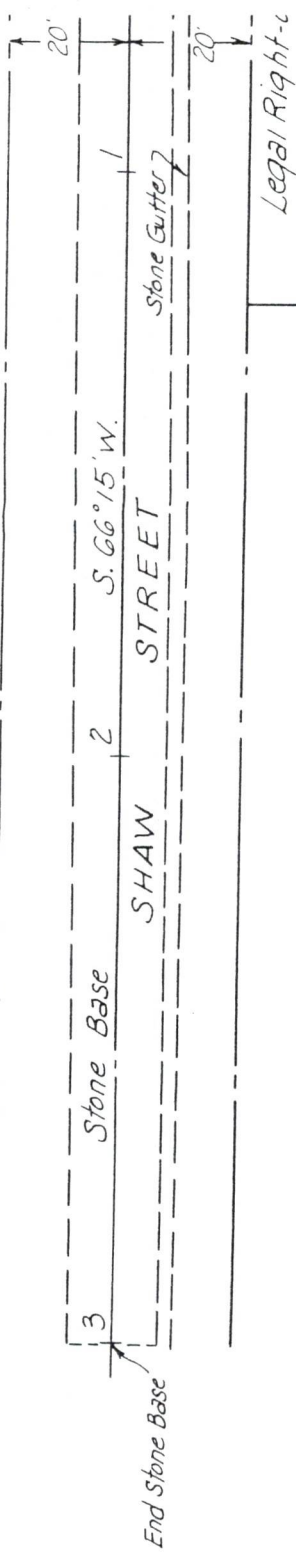

*NOTE: Proposed Twp. Road  
Located Approx. 400' South to  
Moose Cr. Bridge. - L.R. RT. 17117.*



IN THE COURT OF QUARTER SESSIONS OF CLEARFIELD COUNTY, PENNSYLVANIA

RE: ADOPTION OF A PORTION OF :  
SHAW STREET AS A PART OF THE :  
ROAD SYSTEM OF LAWRENCE : No. SS, 1957  
TOWNSHIP :

TO THE HONORABLE JOHN J. PENTZ, PRESIDENT JUDGE:

PETITION PRAYING FOR ADOPTION OF  
SHAW STREET AS PART OF LAWRENCE  
TOWNSHIP ROAD SYSTEM

The Petition of Joseph W. Young, George W. Carns, and  
Bryon Peoples respectfully represents:

(1). They are the duly elected members of the Board of  
Supervisors of Lawrence Township, a municipal subdivision of  
Clearfield County, Pennsylvania.

(2). On the recorded plan of Boyntonville, which said plan  
is of record in the office of the Recorder of Deeds in and for  
Clearfield County, there is shown a street or roadway extending  
in a southwesterly direction from where the same intersects with  
Center Street, otherwise known as Pennsylvania Highway Route No.  
17134, running to the property of the Lawrence Township School  
District, which said plan is incorporated herein by reference.

(3). For over twentyone years prior to the date of the  
hereinafter referred to resolution said Shaw Street or the here-  
inafter designated portion thereof has, from time to time, been  
used as a public thoroughfare as a means of access to and from  
properties abutting the same.

(4). The aforesaid plan of Boyntonville operated as a dedica-  
tion of Shaw Street for public use.

(5). Recent industrial and other development, as well as the  
enlarging of the Plymptonville School in and about Shaw Street, and  
more particularly that portion thereof hereinafter described, has  
made it to the best interest of the Township to accept the dedica-  
tion of said Shaw Street as hereinafter described in order that the  
interests of the property owners abutting the same might be properly  
protected.



(6). Under the provisions of the Second Class Township Code, 53 P.S. 19093-101 et seq., your Petitioners have the power to accept by resolution any roads, streets or alleys as public road if dedicated to such use.

(7). At a regular meeting of the Board of Supervisors of Lawrence Township, your Petitioners, held in Lawrence Township on July 2, 1957, the following resolution was adopted:

WHEREAS, there is designated on the maps of Boyntonville as filled in the office of the Recorder of Deeds in and for Clearfield County, a certain street thereon designated as Shaw Street; and,

WHEREAS, there is nothing among the existing records of the Board of Supervisors of Lawrence Township which would indicate that said Shaw Street or any portion thereof, and the dedication thereof to public use has been accepted by the proper municipal authorities; and,

WHEREAS, it is to the best advantage of the surrounding property owners and Lawrence Township that a portion of said Shaw Street be accepted and adopted as part of the Lawrence Township Road System; and,

WHEREAS, the authority to adopt dedicated roads is vested in the Board of Supervisors of Lawrence Township by virtue of the provisions of the Second Class Township Code.

NOW, THEREFORE, BE IT RESOLVED, that the following described portion of shaw street be and is hereby adopted as part of the road system of Lawrence Township:

ALL that certain piece or parcel of land situate in the Village of Plymptonville, Lawrence Township, Clearfield County, Pennsylvania, the same as appears on the recorded map of Boyntonville as filed in the office of the Recorder of Deeds in and for Clearfield County, Pennsylvania, and so much thereof as follows:

BEGINNING at a point on the South right-of-way line of State Highway No. 17134 (locally known as Guinea Hill Road and shown on the attached map as Center Street); thence south 66 degrees 15 minutes west 284 feet. Being at all times a right-of-way 40 feet in width.

Being the same premises as shown on the attached blueprint.



Now, Therefore, your Petitioners pray your Honorable Court that your Honorable Court approve the acceptance of Shaw Street as designated above, and issue an Order authorizing the same to be added to the road system of the said Lawrence Township.

And they will ever pray.

*Joseph W. Young*  
*Bryon Peoples*  
*Geo W. Carns*

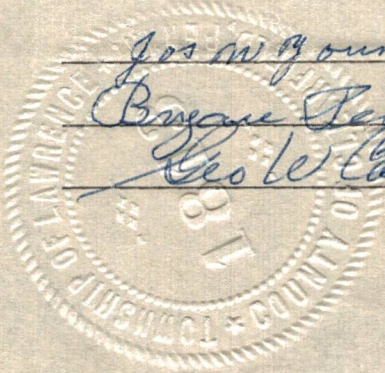

STATE OF PENNSYLVANIA:  
:SS  
COUNTY OF CLEARFIELD :

Before me, the undersigned authority in and for said County and State, came JOSEPH W. YOUNG, GEORGE W. CARNS, and BRYON PEOPLES who, being first duly sworn according to law, depose and say that the facts set forth in the foregoing Petition are true and correct to the best of their knowledge, information and belief.

*Joseph W. Young*  
*Bryon Peoples*  
*Geo W. Carns*

Sworn and subscribed to  
before me this 5<sup>th</sup> day of  
July, 1957.



*Mildred B. Guigher*  
NOTARY PUBLIC  
My Commission Expires  
January 7, 1959



IN THE COURT OF QUARTER SESSIONS OF CLEARFIELD COUNTY, PENNSYLVANIA

RE: ADOPTION OF A PORTION OF :  
SHAW STREET AS A PART OF THE :  
ROAD SYSTEM OF LAWRENCE :No. SS, 1957  
TOWNSHIP :

O R D E R

NOW, to wit, this 5th day of July, 1957, upon consideration of the foregoing Petition, it is hereby ORDERED , ADJUDGED AND DECREED that the following described portion of Shaw Street, as the same appears on the plan of Boyntonville filed in the office of the Recorder of Deeds in and for Clearfield County, Pennsylvania, shall be and is hereby declared to be from this date a part of the Lawrence Township Road System. The portion of Shaw Street affected is described as follows:

ALL that certain piece or parcel of land situate in the Village of Plymptonville, Lawrence Township, Clearfield County, Pennsylvania, the same as appears on the recorded map of Boyntonville as filed in the office of the Recorder of Deeds in and for Clearfield County, Pennsylvania, and so much thereof as follows:

BEGINNING at a point on the South right-of-way line of State Highway No. 17134 (locally known as Guinea Hill Road and shown on the attached map as Center Street); thence south 66 degrees 15 minutes west 284 feet. Being at all times a right-of-way 40 feet in width.

Being the same premises as shown on the attached blueprint.

By the Court,

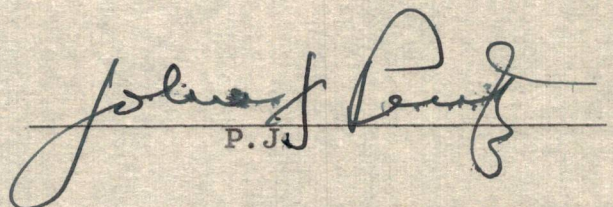
  
P. J.