

ROAD

DOCKET NO. 7

NUMBER TERM YEAR

2 February Sessions, 1961

In re: ABANDONMENT OF ROUTE NO. 17937 (1)

Pike Twp., Clearfield County, Pennsylvania

VERSUS

COMMONWEALTH OF PENNSYLVANIA
Department of Highways
Harrisburg

Abandonment of State Highways

Route 17037(1) County Clearfield Twp. Pike
~~Route~~
~~City~~

Stations of abandoned route from 277+40 to 278+10
(Use Straight Line Diagram Stations)

Stations of relocation from 269+36 to 270+00

Date on which plans were approved by Governor January 8, 1959

Date on which plans were recorded January 19, 1959

Date on which new location was opened to traffic _____

Has old location been put in first class condition? _____

Township

~~County~~

* Abandoned route reverts to ~~County~~
~~City~~

~~Condition of Road~~

* Abandonment data on Separate Sketch

If there are any former county bridges on the abandoned route, report stations, name of streams, condition of bridges, as well as any occupancy permits which may be in effect _____

Are any intersecting routes to be lengthened or shortened? Give details.

COMMONWEALTH OF PENNSYLVANIA

Department of Highways

INSPECTION OF ROADS

TO BE ABANDONED

AS STATE HIGHWAYS

DATE

Route 17037 Section 1, Clearfield County Pilbo ~~BOOK~~
Twp. ~~CITY~~Station 277+40 to Station 278+10Type of Pavement 14' Mac. Width of Graded Section 24'

Condition at time of Inspection _____ 19__

Surface

Shoulders

Drainage

Bridges

Miscellaneous

Number of Department Owned Signs to be Removed _____

Work required to place road in First-class Condition _____

SUPERVISORS PROPOSE TO VACATE:

(Use reverse side if necessary)

It is agreed that the completion of the work listed above will place this road in First-class Condition.

District Engineer_____
For Local Authorities

The work listed above has been completed and the road is in First-class Condition.

E. W. Anderson
Raymond Long_____
Date

Frank Decker 7-
2 Feb 1961
Page 285

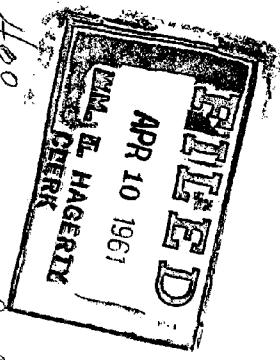

400 -
H. J. Foster, Secy
Course no. 101

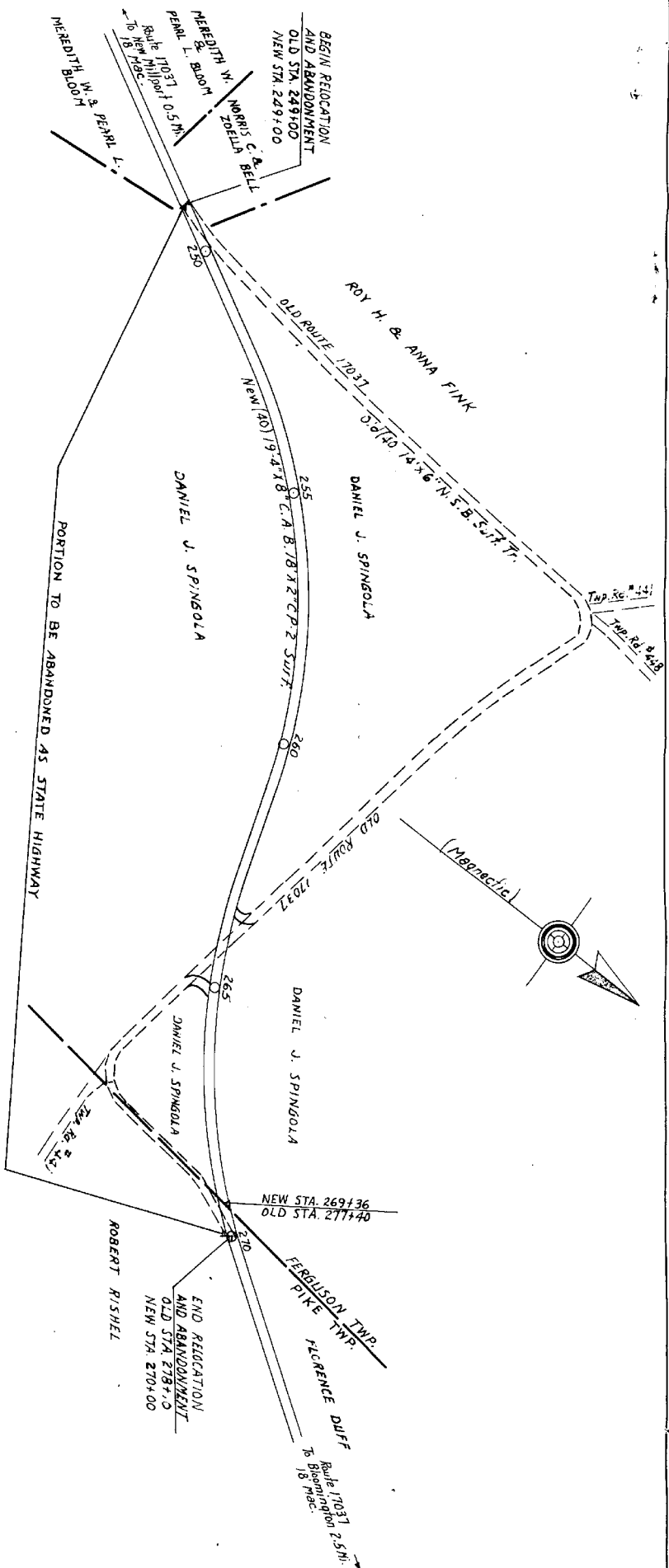

SKETCH

SHOWING PORTION OF STATE HIGHWAY ROUTE 17037-1

TO BE ABANDONED

FERGUSON & PIKE TWS. CLEARFIELD CO.

POLITICAL	ROUTE CHANGED FROM	LENGTH	RELOCATION	ABANDONMENT
SUB-DIVISION	STATION TO STATION	IN FEET	IMPROVED(MI.)	IMPROVED(MI.)
FERGUSON TWP	249+00-269+36	2036'	0.3856	
FERGUSON TWP	249+00-277+40	2840'		0.5379
PIKE TWP	269+36-270+00	64'	0.0121	
PIKE TWP	277+40-278+10	70'		0.0133
	TOTALS		0.3977	0.5512

SCALE 1"=200'

NOTE: Construction plans covering relocation, approved by the Governor, January 8, 1959.